

TIE DOWNS



OEM TRAILER

ABOUT TIE DOWN

ENGINEERING AND PRODUCT DEVELOPMENT

At Tie Down, we take pride in the products we bring to market. After identifying a product opportunity, we develop our products via an ISO 9001:2015 certified agile process. Each OEM product is designed in CAD, validated using Finite Element Analysis, and then verified with physical testing.

TIE DOWN

MANUFACTURING INGENUITY



TIE DOWN TABLE OF CONTENTS

FENDERS

Metal Fenders

Custom Metal Fenders	4
Custom Metal Fender Skirts	5
Powder Coat Fenders	5
Single Axle	6-9
Tandem Axle	10-16
Triple Axle	17

Plastic Fenders

High Impact: Single Axle	18
High Impact: Tandem & Triple Axle	19
PWC "Bracket-less" Fender	20
8-12" Plastic Fenders	20
14-15" Plastic Fenders	20
Heavy Duty with Tail Light Retainer	21

Mounting Brackets & Steps

Mounting Brackets	22
Mounting Steps	23-24

U-BOLTS

Common U-bolts	25
Common Fasteners	25

BOW STANDS

Bow Stands, Base	26-29
Winch Mounts	30-32
Combinations	33-36

FRAME COMPONENTS

Frame Rails	37
Crossmembers	37
Tongues	38
Swing Tongues	38

GUIDE ON'S & ACCESSORIES

Pontoon Guide On's	39
Side Guide On's	40
Bow Guide On's	40-41

BRACKETS

Channel Brackets	42
Pontoon Bunk Brackets	43
Vertical Bunk Brackets	44
Bunk Brackets	45
Bolster & Swivel Brackets	46
Accessories	47

ROLLERS & BUNK SLICKS

Rollers & Bunk Slicks	48-52
Wobble Roller Bunks	53
Keel Roller & Panel Brackets	54
Roller Shafts & Cap Nuts	55

CABLES, CHAINS, & STRAP

Hitch Cables	56
Safety Chains	57
Winch Straps & Cable	58
Hooks	59

SPARE TIRE CARRIERS

Eliminator with Spindle Carriers	60
Side Mount Carriers	61
Heavy Duty Carriers	62

FENDERS

CUSTOM FENDERS

Tie Down offers single-axle, tandem-axle, and tri-axle fenders in a wide range of styles, sizes, and materials. With over 1,000 variations already in production, we can either match you with an existing fender or create a custom option to perfectly match your needs. Please browse through many of our popular fenders. If you require a different size, style, material, or finish, please contact Tie Down at 404-344-0000. The following information will be needed:

1) Number of Axles

- Single Axle (1) Tandem Axle (2) Tri-Axle (3)

2) Style

- Round Jeep Drop Leg Jeep (Double Bend)
 Round w/Valance *(not on single axle) Jeep w/Valance *(not on single axle) Drop Leg w/Valance *(not on single axle)

3) Flange Style

- Radius/Radius Radius/Square Radius/Tapered Radius/Flare

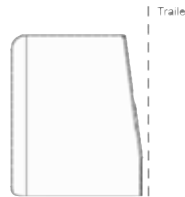
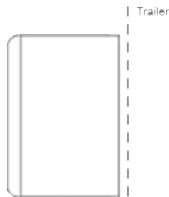
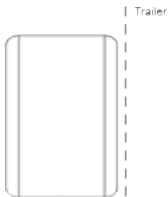

4) Dimensions

Width (in.) _____

Length (in.) _____

Height (in.) _____

5) Material

- 18 gauge Steel (CR) 16 ga. Galvanized Steel Aluminum Tread .063
 16 gauge Steel (CR) 16 ga. Galvanized Steel Aluminum Tread .080
 14 gauge Steel (CR) (Painted Preferred) Aluminum Tread .100
 14 gauge Steel (CR) Aluminum Smooth .063
Floor/Diamond Plate Aluminum Smooth .100

FENDER SKIRT/BACK

Tie Down offers laser cut fender skirts/back on many fenders today. We can also add to any fender you would prefer. Fender skirts/back can either be pre-welded to the fender or sold separately. Tie Down will design to match specific fender dimensions so please let us know which fender you're matching and the overall height of the skirt/back.

1) Fender SKU

Part ID: _____ *(or provide a drawing)

2) Skirt/Back Height _____ (inches)

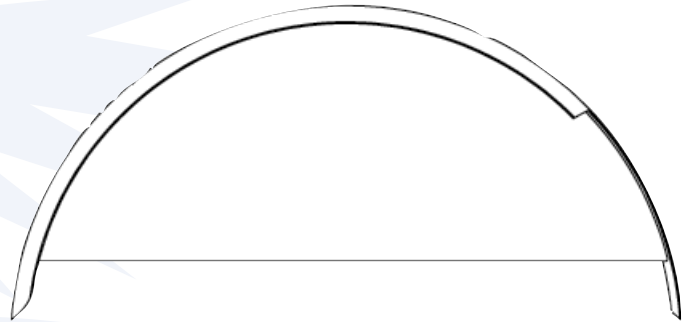

3) Material

- | | | |
|--|--|---|
| <input type="checkbox"/> 18 gauge Steel (CR) | <input type="checkbox"/> 16 ga. Galvanized Steel | <input type="checkbox"/> Aluminum Tread .063 |
| <input type="checkbox"/> 16 gauge Steel (CR) | <input type="checkbox"/> 16 ga. Galvanized Steel | <input type="checkbox"/> Aluminum Tread .080 |
| <input type="checkbox"/> 14 gauge Steel (CR) | <input type="checkbox"/> 16 ga. Galvanized Steel | <input type="checkbox"/> Aluminum Tread .100 |
| <input type="checkbox"/> 14 gauge Steel (CR) | (Painted Preferred) | <input type="checkbox"/> Aluminum Smooth .063 |
| Floor/Diamond Plate | | <input type="checkbox"/> Aluminum Smooth .100 |

POWDER COAT FENDERS

Tie Down has two powder coating facilities in-house to offer high-quality and affordable powder coat fenders. Most customers prefer a smooth black color over aluminum tread-brite material, however we have the ability to paint many colors and textured finishes for your custom needs. Please contact us for more information.



FENDERS

SINGLE AXLE

Round - 1" Radius both sides

The following fenders are single axle, round in shape, and feature a 1" radius flange on both sides. Tie Down can create these fenders in 7", 8", 9", 10", 10.75", and 12" widths. Please browse through some of our common sizes below.

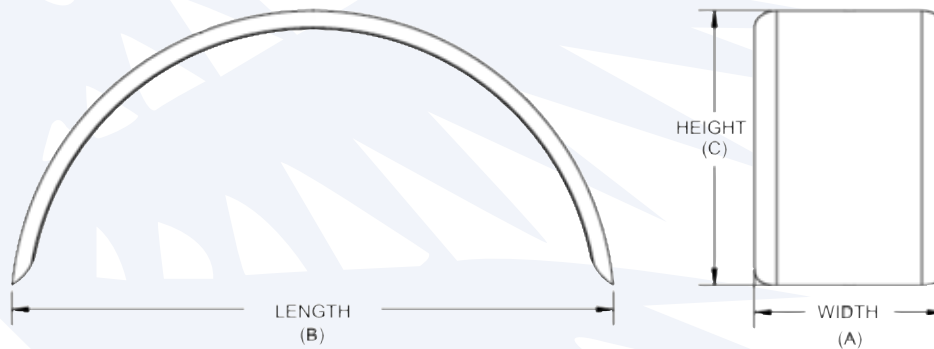

Part ID	Width (A)	Length (B)	Height (C)	Wheel Size	Material	Stocked
44316	7"	20"	6"	8"	16 ga - CR	
86264	7"	20"	6"	8"	16 ga - Galv	Yes
44317	7"	23.5"	6.5"	12"	16 ga - CR	
86265	7"	23.5"	6.5"	12"	16 ga - Galv	Yes
44266	7"	27"	13"	12"	16 ga - CR	Yes
44217	7"	28"	10"	12"	16 ga - CR	
44299	7"	28"	10"	12"	16 ga - Galv	
44300	7"	28"	10"	12"	.080 - AT	
70705	8"	27.5"	11"	13"	16 ga - CR	
86266	8"	27.5"	11"	13"	16 ga - Galv	Yes
44872HD	9"	31"	15"	14"	.100 - AT	
86267	9"	31.5"	13"	14"	16 ga - Galv	Yes
44921	9"	32"	16"	15"	16 ga - Galv	
44917	10"	31.5"	13"	14"	16 ga - CR	
44939HD	10"	32"	16"	15"	.100 - AT	

SINGLE AXLE

Round - 1" Radius Front, 90° Square back

The following fenders are single axle, round in shape, and feature a 1" radius flange on one side with a 90 degree square flange on the mounting side. Tie Down can create these fenders in 7", 8", 9", 10", 10.75", and 12" widths. Please browse through some of our common sizes below.

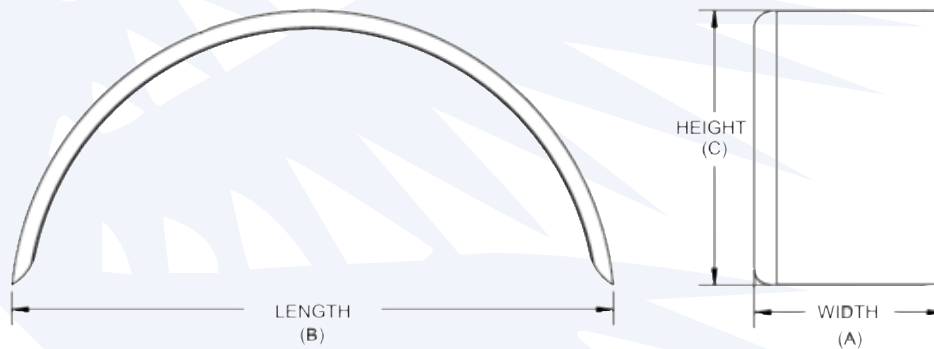

Part ID	Width (A)	Length (B)	Height (C)	Wheel Size	Material	Stocked
44214	8"	28"	10"	13"	16 ga - CR	Yes
44916-1	9"	32"	15"	15"	16 ga - CR	Yes
48271	9"	32"	15"	15"	.100 - AT	
44281	9"	33"	18"	15"	.063 - SA	
44281AT	9"	33"	18"	15"	.063 - AT	
44116SA	9"	34"	18"	15"	.063 - SA	
44116	9"	34"	18"	15"	.063 - AT	
44115SA	9"	35"	20"	16"	.063 - SA	
44115	9"	35"	20"	16"	.063 - AT	
44114SA	10"	33"	19"	15"	.063 - SA	
44114	10"	33"	19"	15"	.063 - AT	
44113SA	10"	34"	18"	15"	.063 - SA	Yes
44113	10"	34"	18"	15"	.063 - AT	Yes
44118	10.75"	32"	16"	15"	16 ga - CR	
44119	10.75"	36"	18"	16"	16 ga - CR	

FENDERS

SINGLE AXLE

Round - 1" Radius Front, Tapered Back

The following fenders are single axle, round in shape, and feature a 1" radius flange on one side and a tapered/slant design on the mounting side. Each fender features a continuous flange edge through the entire fender for mounting. Tie Down can create these fenders with a 9.25" bottom width tapered to 7.75" top width.

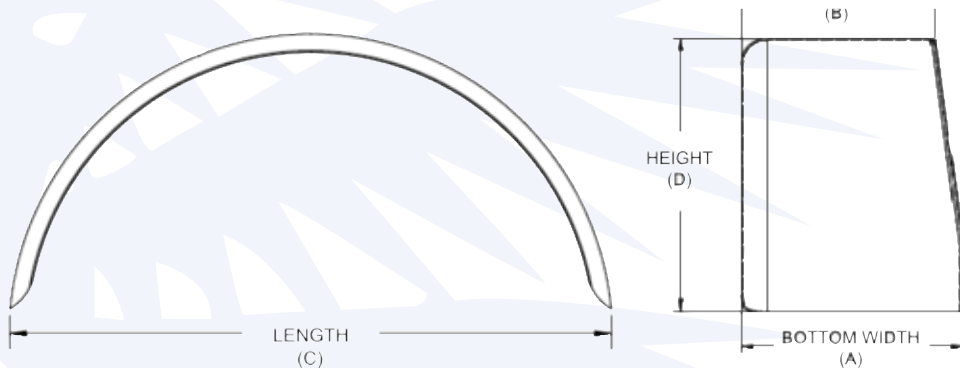

Part ID	Bottom Width (A)	Top Width (B)	Length (C)	Height (D)	Wheel Size	Material
44213	9.25"	7.75"	27"	11.25"	12"	16 ga - CR
44790	9.25"	7.75"	28"	11"	12"	16 ga - CR
44790G	9.25"	7.75"	28"	11"	12"	16 ga - Galv
44791	9.25"	7.75"	31"	13.25"	14"	16 ga - CR
44791G	9.25"	7.75"	31"	13.25"	14"	16 ga - Galv
43742	9.25"	7.75"	31"	15.5"	15"	16 ga - CR
43742G	9.25"	7.75"	31"	15.5"	15"	16 ga - Galv

Round - 1" Radius Front, tabbed Tapered Back

Tie Down also has the ability to produce tabbed tapered fenders, in non-standard widths (standard - 9.25" bottom width tapered to 7.75" top width). A tabbed tapered fender does not feature a continuous mounting flange on the tapered side, but instead has tabs located along the edge for mounting. Please contact us for more information.

SINGLE AXLE

Jeep Style - 0.56" Radius Both Sides, 70 degree

The following fenders are single axle, jeep-style, and feature a 0.56" radius flange on both sides. Each fender features a single break at 70 degrees. Tie Down can create these fenders in 7", 8", 9", and 10" widths. Please browse through some of our common sizes below.

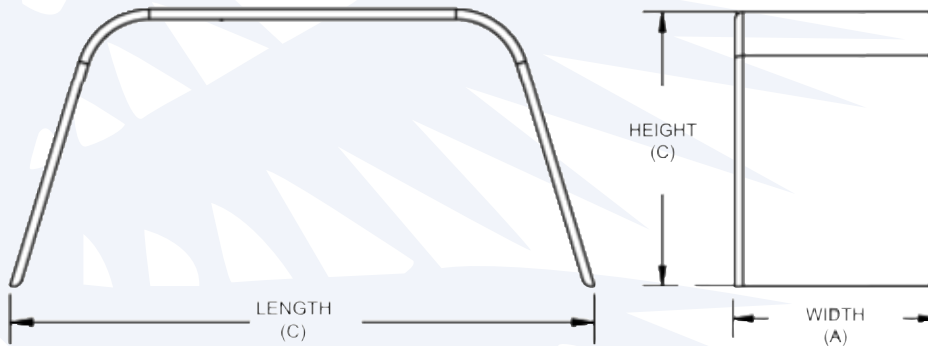

Part ID	Width (A)	Length (B)	Height (C)	Wheel Size	Material	Stocked
44976	7"	23.75"	8.5"	8"	16 ga - CR	
44261	8"	24"	9"	12"	16 ga - CR	
44117SA	8"	26"	10"	13"	.063 - SA	
44117	8"	26"	10"	13"	.063 - AT	
44262	8"	28"	12"	13"	16 ga - CR	
44252SA	9"	32"	15.5"	15"	.063 - SA	Yes
44252	9"	32"	15.5"	15"	.063 - AT	Yes
44282SA	9"	36"	18.25"	15"	.063 - SA	
44282	9"	36"	18.25"	15"	.063 - AT	
44807	10"	32"	13"	15"	16 ga - CR	
44251SA	10"	34"	18"	16"	.063 - SA	Yes
44251	10"	34"	18"	16"	.063 - AT	Yes
44925-1	10"	36"	19"	16"	16 ga - CR	

FENDERS

TANDEM AXLE

Round - 1" Radius Both Sides

The following fenders are tandem axle, round in shape, and feature a 1" radius flange on both sides. Tie Down can create these fenders in 7", 8", 9", 10", 10.75", and 12" widths. Please browse through some of our common sizes below.



Part ID	Width (A)	Length (B)	Height (C)	Wheel Size	Material	Stocked
44978	7"	64"	11.5"	12"	16 ga - CR	
48273	9"	60.75"	12"	13"	16 ga - CR	
44929	9"	61.25"	10.25"	13"	16 ga - CR	
48272HD	9"	62"	14"	14"	.100 - AT	
44990	9"	65"	15"	15"	.100 - AT	
44878	9"	66"	16"	15"	16 ga - CR	
44728	9"	68"	16"	15"	.080 - AT	
48276	10"	65"	15"	15"	.100 - AT	
44739HD	10"	68"	14"	15"	.100 - AT	
44743HD	10"	68"	16"	15"	.100 - AT	
44245HD	10"	68"	18"	16"	.100 - AT	
44750HD	10"	74"	18"	16"	.100 - AT	

TANDEM AXLE

Round - 1" Radius Both Sides with Valance

The following fenders are tandem axle, round in shape, has a 1" radius flange on both sides, and features a valance (teardrop). Tie Down can create these fenders in 7", 8", 9", 10", 10.75", and 12" widths. Please browse through some of our common sizes below.

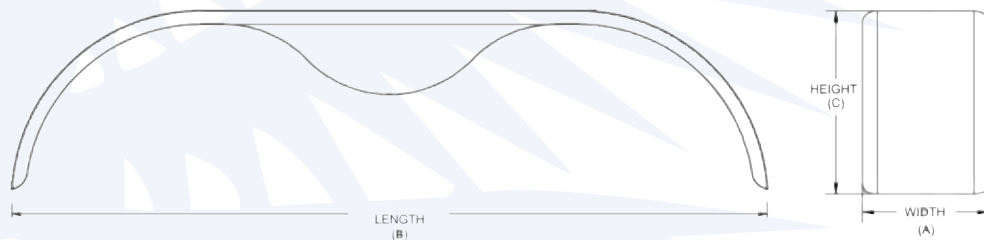

Part ID	Width (A)	Length (B)	Height (C)	Wheel Size	Material	Stocked
44979	7"	64"	12"	13"	16 ga - CR	
44216	7"	66"	14"	14"	16 ga - CR	
44223	9"	65"	13"	14"	16 ga - CR	
44224	9"	65"	15"	15"	16 ga - CR	Yes
45066	9"	66"	16"	15"	16 ga - CR	
43037	9"	68"	16"	15"	16 ga - CR	
44421	9"	68"	17"	15"	.080 - AT	
44824	9"	68"	17"	15"	16 ga - Galv	
43740	9"	72"	17"	15"	16 ga - CR	
43740G	9"	72"	17"	16"	16 ga - Galv	
44966	10"	66"	18"	16"	16 ga - CR	
44934RR	10"	72"	20.5"	16"	16 ga - CR	

FENDERS

TANDEM AXLE

Round - 1" Radius Front, 90° Square Back

The following fenders are tandem axle, round in shape, and feature a 1" radius flange on one side with a 90 degree square flange on the mounting side. Tie Down can create these fenders in 7", 8", 9", 10", 10.75", and 12" widths. Please browse through some of our common sizes below.



Part ID	Width (A)	Length (B)	Height (C)	Wheel Size	Material	Stocked
44831	7"	64"	12.5"	13"	.080 - AT	
44779	9"	64"	12.5"	14"	.080 - AT	
44980-1	9"	65"	15"	15"	16 ga - CR	
44221	9"	68"	16"	15"	.100 - AT	
44808	9"	72"	15"	15"	16 ga - CR	
44443-1	9"	72"	19.5"	16"	16 ga - CR	
45069	10"	66"	15"	15"	16 ga - CR	
44743RS	10"	68"	16"	16"	.080 - AT	
44985	10"	68"	16"	16"	.100 - AT	
44444-1	10"	76"	17"	16"	14 ga - DP	

TANDEM AXLE

Round - 1" Radius Front, 90° Square Back with Valance

The following fenders are tandem axle, round in shape, and feature a 1" radius flange on one side with a 90 degree square flange on the mounting side. Each fender includes a valance (teardrop). Tie Down can create these fenders in 7", 8", 9", 10", 10.75", and 12" widths. Please browse through some of our common sizes below.

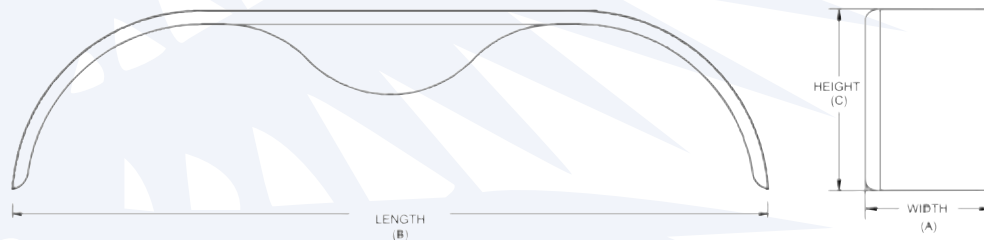

Part ID	Width (A)	Length (B)	Height (C)	Wheel Size	Material	Stocked
44982-1	9"	65"	15"	15"	16 ga - CR	
44143	9"	66"	18"	15"	.063 - AT	
44932-1	9"	66"	19"	15"	16 ga - CR	
44284	9"	68"	18.25"	15"	.063 - AT	
44253	9"	72"	18"	16"	.063 - AT	Yes
44144	9"	72"	19"	16"	.063 - AT	
44169	9"	72"	20.5"	16"	14 ga - DP	
44254	9"	75"	20"	16"	.063 - AT	
44145	10"	66"	14"	15"	.063 - AT	
44146	10"	66"	18"	15"	.063 - AT	Yes
44147	10"	68"	19.5"	15"	.063 - AT	
44255	10"	72"	18"	16"	.063 - AT	Yes
44148	10.75"	72"	18"	16"	.063 - AT	
44270	10.75"	72"	20"	16"	16 ga - CR	
44219	10.75"	72"	20"	16"	14 ga - DP	
44149	10.75"	72"	20"	16"	.063 -AT	

FENDERS

TANDEM AXLE

Round - 1" Radius Front, Tapered Back with Valance

The following fenders are tandem axle, round in shape, and feature a 1" radius flange on one side and a tapered/slant design on the mounting side. Each fender features a continuous flange edge through the entire fender for mounting. Tie Down can create these fenders with a 9.25" bottom width tapered to 7.75" top width.

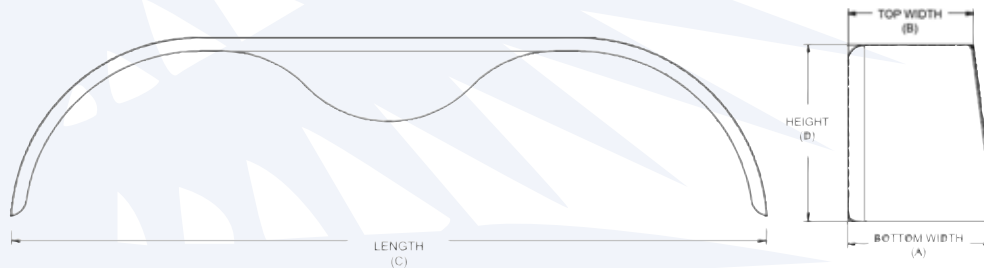

Part ID	Bottom Width (A)	Top Width (B)	Length (C)	Height (D)	Wheel Size	Material
44250	9.25"	7.75"	65"	15"	14"	.100 - SA
44182	9.25"	7.75"	65"	15"	14"	16 ga - CR
43741	9.25"	7.75"	66"	15"	14"	16 ga - CR
43741G	9.25"	7.75"	66"	15"	14"	16 ga - Galv

Round - 1" Radius Front, Tabbed Tapered Back

Tie Down also has the ability to produce tabbed tapered fenders, in non-standard widths (standard - 9.25" bottom width tapered to 7.75" top width). A tabbed tapered fender does not feature a continuous mounting flange on the tapered side, but instead has tabs located along the edge for mounting. Please contact us for more information.

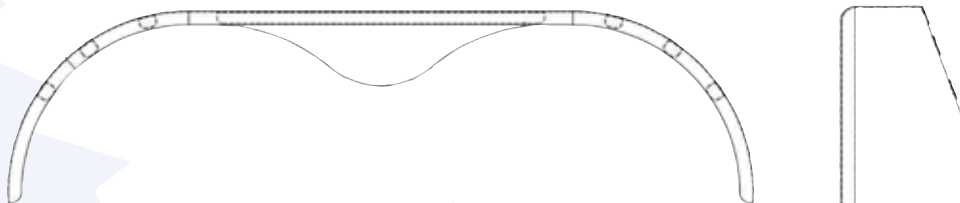

TANDEM AXLE

Jeep Style - 0.56" Radius Both Sides, 70 degree

The following fenders are tandem axle, jeep-style, and feature a 0.56" radius flange on both sides. Each fender features a single break at 70 degrees. Tie Down can create these fenders in 7", 8", 9", and 10" widths. Please browse through some of our common sizes below.



Part ID	Width (A)	Length (B)	Height (C)	Wheel Size	Material	Stocked
44445-1	9"	72"	20"	15"	14 ga - DP	
44933	10"	68"	13.25"	15"	16 ga - CR	
44121	10"	72"	13"	15"	14 ga - DP	
44413	10"	72"	18.5"	15"	14 ga - DP	
44829-1	10"	72"	20"	15"	14 ga - DP	
44414	10"	76"	15.5"	16"	14 ga - DP	
44881-1	10"	76"	20"	16"	14 ga - DP	
44240	10"	78"	18"	16"	14 ga - DP	

FENDERS

TANDEM AXLE

Jeep Drop Leg - 0.56" Radius Both Sides

The following fenders are tandem axle, jeep drop leg style (double bend), and feature a 0.56" radius flange on both sides. Tie Down can create these fenders in 7", 8", 9", and 10" widths.



Part ID	Width (A)	Length (B)	Height (C)	Wheel Size	Material	Stocked
44271	9"	72"	17"	15"	14 ga - DP	

Jeep Drop Leg - 0.56" Radius Both Sides with Valance

The following fenders are tandem axle, jeep drop leg style (double bend), and feature a 0.56" radius flange on both sides. Each fender includes a valance (teardrop) design. Tie Down can create these fenders in 7", 8", 9", and 10" widths. Please browse through some of our common sizes below.

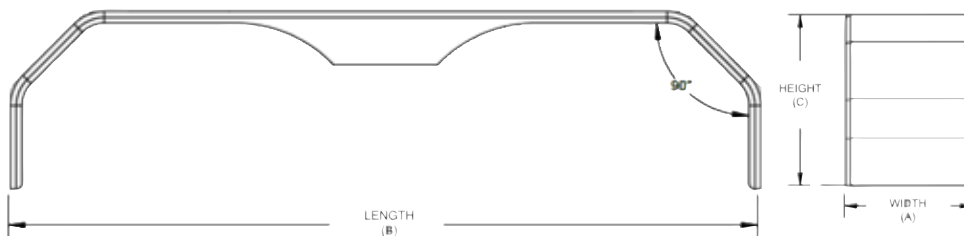

Part ID	Width (A)	Length (B)	Height (C)	Wheel Size	Material	Stocked
44291	9"	72"	16"	15"	14 ga - DP	
44264	9"	72"	17"	15"	14 ga - DP	
44290	10"	72"	16"	15"	14 ga - DP	
44265	10"	72"	17"	15"	14 ga - DP	
44292	10"	72"	20"	15"	14 ga - DP	

TRIPLE AXLE

Round - 1" Radius Both Sides

The following fenders are triple axle, round in shape, and feature a 1" radius flange on both sides. Tie Down can create these fenders in 7", 8", 9", 10", 10.75", and 12" widths.

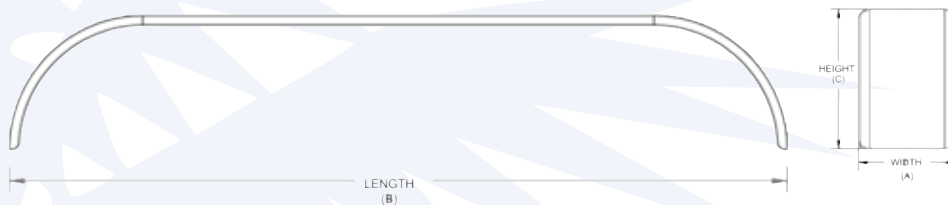

Part ID	Width (A)	Length (B)	Height (C)	Wheel Size	Material	Stocked
44742	9"	98"	16"	15"	.080 - AT	
44736	9"	102"	18"	15"	.100 - AT	
43738	9"	108"	18"	16"	.100 - AT	
44735HD	10"	102"	17.5"	15"	.100 - AT	
44874HD	10"	103"	17"	15"	.100 - AT	
44751HD	10"	110"	20"	16"	.100 - AT	
44294	12"	110"	18"	16"	.100 - AT	

Round - 1" Radius Both Sides with Valance

The following fenders are triple axle, round in shape, and feature a 1" radius flange on both sides. Each fender includes a valance (teardrop) design. Tie Down can create these fenders in 7", 8", 9", 10", 10.75", and 12" widths.

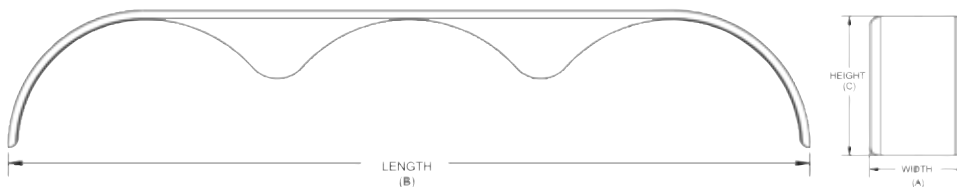

Part ID	Width (A)	Length (B)	Height (C)	Wheel Size	Material	Stocked
44950	10"	97"	15.5"	15"	16 ga - CR	
44951	10"	105"	18"	16"	16 ga - CR	

FENDERS

HIGH IMPACT MODULAR FENDERS

The "SUV" styled fenders are corrosion proof, high impact resistant and have a molded-in color that is scratch resistant. Injection molding assures consistent quality of shape and finish. The modular design allows mix and match sections to handle single, double and triple axle trailers for 14/15" tires and wheels. Also single and tandem sections for 13" tires and wheels.



13 IN. PLASTIC FENDER

Black Part ID: **44320PC**
Silver Part ID: **44320S**

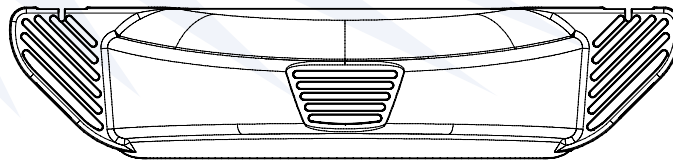
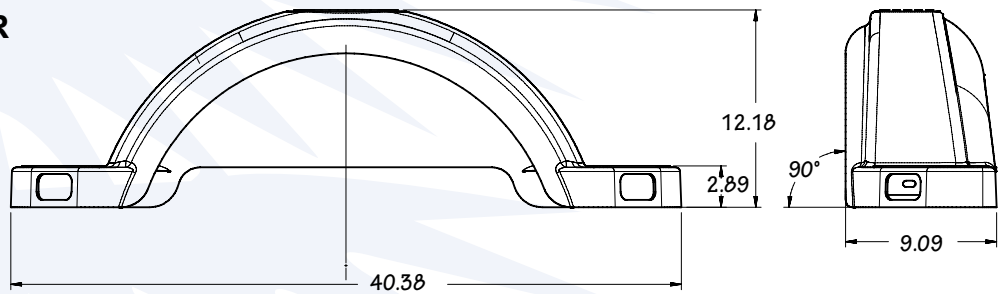

14 IN. -15 IN. PLASTIC FENDER

Black Part ID: **44342PC**
Silver Part ID: **44342S**

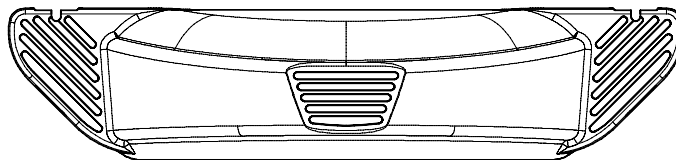
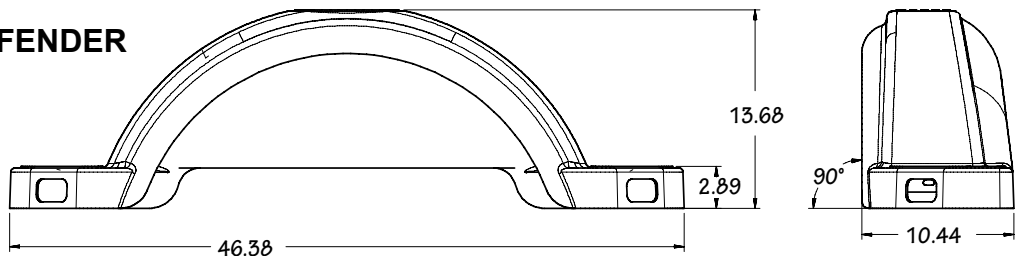

Note: Fenders available with or without side marker light cutouts.

Dual axle configurations utilize individually molded front and rear fenders that are designed to bolt together without modifications. The result is a clean custom fender design.

The triple axle fender combination uses a unique middle fender design that is mated in between the front and rear fenders. Step plates are designed into the fenders completing the custom look.



13 IN. TANDEM FENDER

Black Part ID: **44321PC**

Silver Part ID: **44321S**

13 IN. TANDEM

(Opposite) Fender

Black Part ID: **44327PC**

Silver Part ID: **44327S**

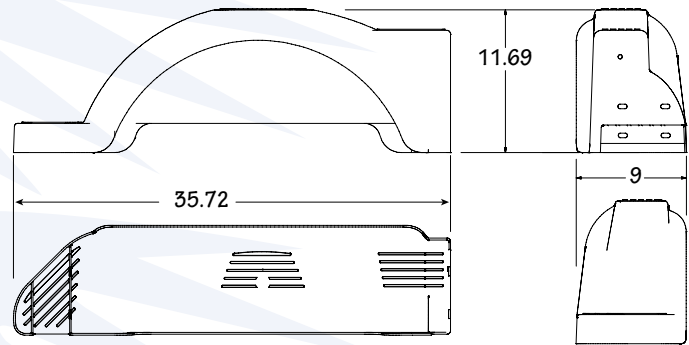

Note: Fenders available with or without side marker light cutouts.

14 IN. - 15 IN. TANDEM FENDER

Black Part ID: **44343PC**

Silver Part ID: **44343S**

14" - 15" TANDEM

(Opposite) Fender

Black Part ID: **44344PC**

Silver Part ID: **44344S**

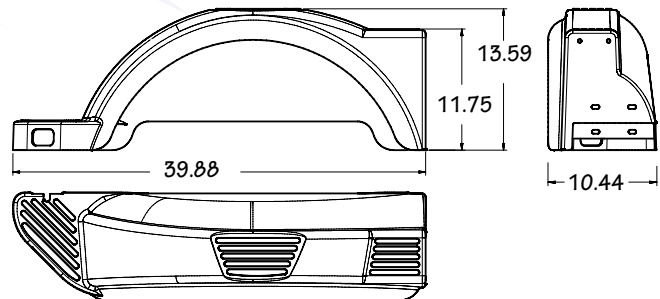

Note: Fenders available with or without side marker light cutouts.

14 IN. - 15 IN. TRI-AXLE FENDER

Black Part ID: **44345PC**

Silver Part ID: **44345S**

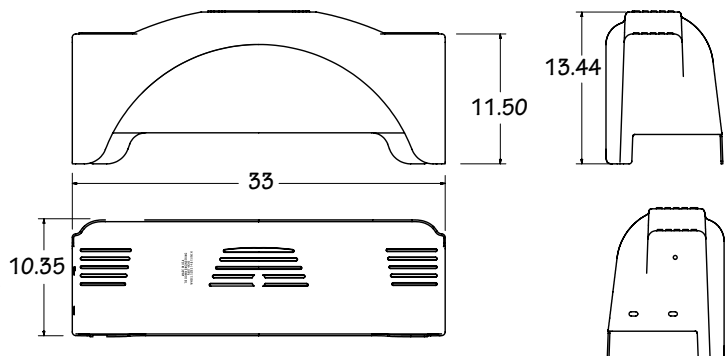

FENDERS

“BRACKET-LESS FENDER”

High impact plastic fender designed to mount directly to your frame without using fender brackets. Fender position is easily changed. You save on labor and parts. Designed for wheels up to 12 in.

Black Fender Part ID: **43785PC**
Silver Fender Part ID: **43785S**

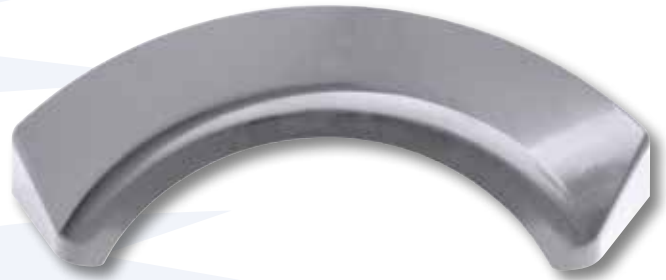

8 IN. -12 IN. PLASTIC FENDER

High impact polyethylene plastic fender for 8 in.-12 in. wheels. Perfect for PWC and small skiff trailers. White or black standard, custom colors available with minimum run orders. Mounts with #44204 offset bracket or #44203 flush mount bracket.

White Plastic Fender Part ID: **17026**
Black Plastic Fender Part ID: **17033**
Silver Plastic Fender Part ID: **17026S**



14 IN. -15 IN. PLASTIC STEP FENDER

High impact polyethylene plastic step fender for 14 in. or 15 in. wheels. The fender is designed to be used on tandem and triple axle trailers by cutting the step at pre-determined locations to bolt the fenders together. Custom colors available with minimum run orders. Mounts with #44141 mounting bracket.

Black Fender Part ID: **44331**
White Fender Part ID: **44332**



HEAVY DUTY PLASTIC FENDER

Tie Down heavy fenders are designed for extreme use with optional front and rear light knockouts. Tail light retainer provides additional support to remove the problem of vibration damage and lost lights. Fits 13 in. wheels.

HEAVY DUTY FENDER

Available with or without tail light cutouts.

White Part ID: **44353**
 Black Part ID: **44353B**

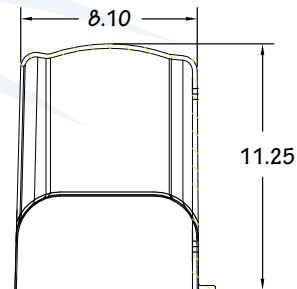
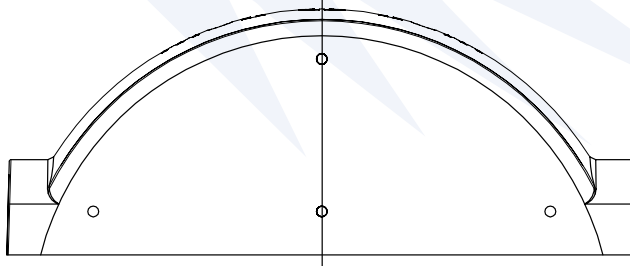
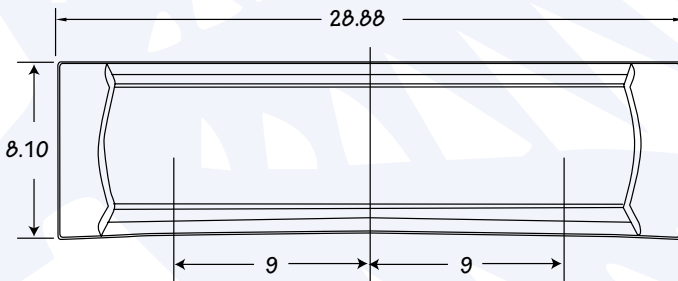

TAIL LIGHT RETAINER

Manufactured for standard 6.50 in. x 2.25 in. oval stock tail light kits.

White Part ID: **44704**
 Black Part ID: **44704B**

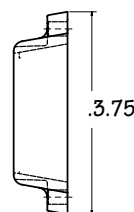
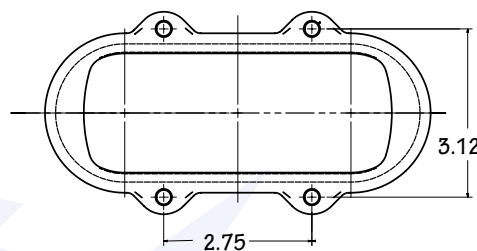

FENDERS

FLUSH MOUNT FENDER BRACKET

For 8 in. -12 in. metal fenders
fits 3" channel, galvanized.

Part ID: 44203

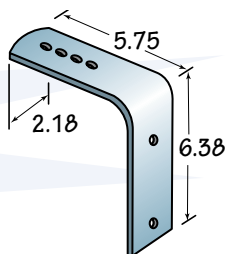

FENDER BRACKET

For 8 in.-12 in. plastic fenders,
fits 3 in. channel, galvanized.

Part ID: 44205

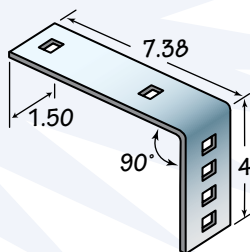

DOUBLE MOUNT FENDER BRACKETS

For 8 in.-12 in. metal fenders
fits 3 in. channel, galvanized.

Part ID: 44207

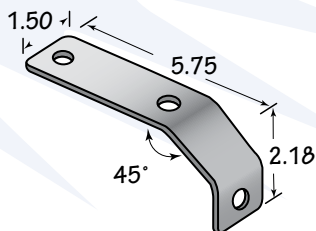

UNIVERSAL MOUNTING BRACKET

Offset fits 3 in. channel, galvanized.

Part ID: 44204

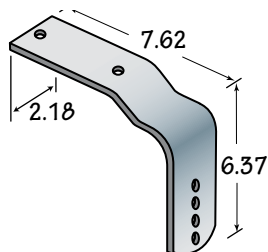

SINGLE BRACKET "WELD ON" FENDER MOUNT

For use with fender #44752 and with
other top center hole mount fenders,
raw unfinished steel.

Part ID: 43776

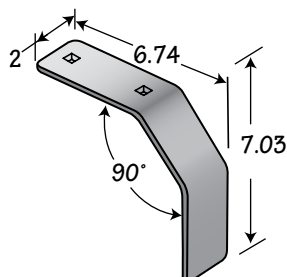

FENDER STEP BRACKETS

Part ID:	A	B	C	Notes
44135	4 in.	14.37 in.	2 in.	Fits 3 in. channel
44141	2.65 in.	13.22 in.	1.18 in.	Fits 3 in. channel - single, double and triple mounts
44161	3.90 in.	15.25 in.	1.18 in.	

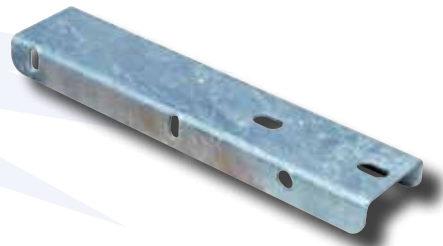
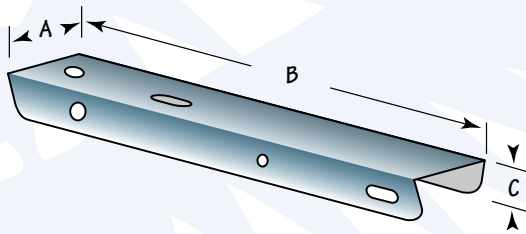

WELD ON FENDER STEP BRACKET

Brackets weld on to the trailer frame. Fenders are then bolted to the fender step; available left and right hand.

Part ID: 44153L
Part ID: 44153R

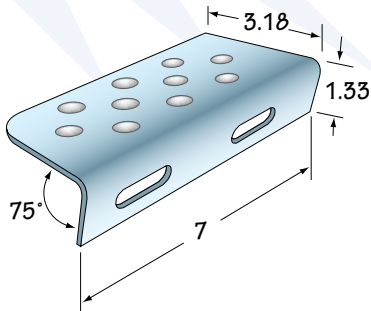

WELD ON MODULAR FENDER MOUNTING BRACKET

Fenders are bolted over the mounting bracket. Used with fenders shown pages 7 and 8. Available left and right hand. Raw unfinished steel.

Part ID: 44186-2L
Part ID: 44186-2R

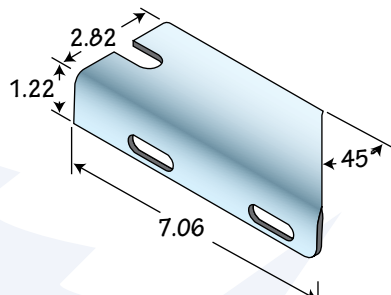

FENDERS

WELD ON FENDER STEP BRACKET

Brackets weld on to the trailer frame. Fenders are then bolted to the fender step; available left and right hand. Raw unfinished steel.

Part ID: **42093L**

Part ID: **42093R**

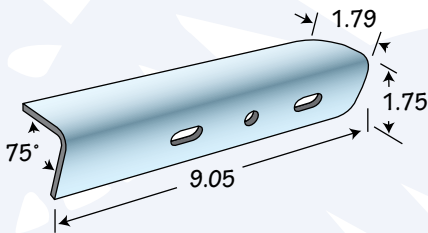

FENDER STEPS

Weld on fender steps are available with optional aluminum diamond tread brite overlay. Available left and right hand.

Fender Step

Part ID: **44757L**

Part ID: **44757R**

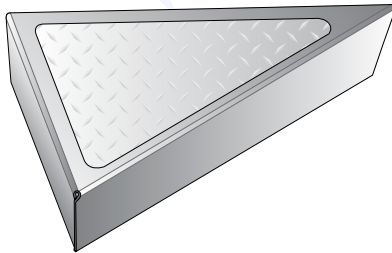

Fender Step Overlay

Part ID: **44757L-O**

Part ID: **44757R-O**

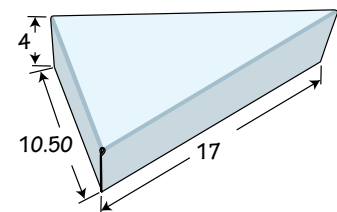
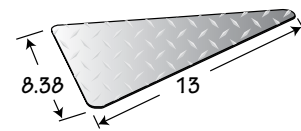

Fender Step

Part ID: **4758L**

Part ID: **44758R**

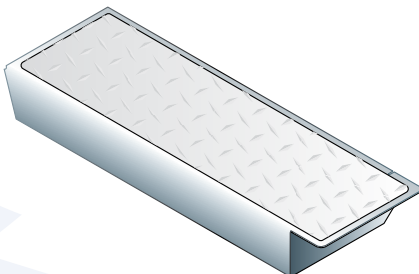

Fender Step Overlay

Part ID: **44758-O**

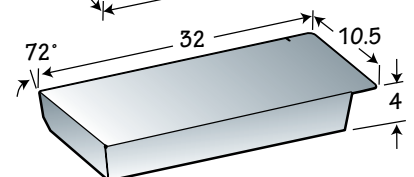
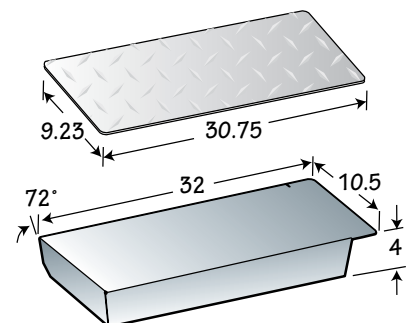

U-BOLTS

Part #	Shape	"A"	"B"	"C"	"D"
83009	Square	3/8 in.-16	1.56 in.	2.63 in.	1.75 in.
83006	Square	3/8 in.-16	2.06 in.	3.88 in.	1.75 in.
83003	Square	3/8 in.-16	2.06 in.	4.38 in.	1.75 in.
83036	Square	3/8 in.-16 in.	3.06 in.	2.56 in.	.88 in.
83068	Square	3/8 in.-16	3.06 in.	3.88 in.	1 in.
83027	Square	3/8 in.-16	3.06 in.	2.38 in.	1.75 in.
83018	Square	3/8 in.-16	3.06 in.	3.88 in.	1.75 in.
83033	Square	3/8 in.-16	4.06 in.	3.75 in.	1 in.
83701	Square	7/16 in.-14	3.06 in.	2.81 in.	1.75 in.
84404	Square	1/2 in.-13	2.06 in.	4.31 in.	1.75 in.
84405	Square	1/2 in.-13	2.06 in.	5.31 in.	1.75 in.
84411	Square	1/2 in.-13	2.06 in.	6.31 in.	2 in.
84406	Square	1/2 in.-13	2.06 in.	4.81 in.	2 in.
84438	Square	1/2 in.-13	2.31 in.	5.75 in.	2 in.
84408	Square	1/2 in.-13	2.06 in.	5.81 in.	2 in.
84750	Round	1/2 in.-13	2.56 in.	5.88 in.	1.75 in.
84444	Square	1/2 in.-13	3.06 in.	2.31 in.	1.5 in.
84400	Square	1/2 in.-13	3.06 in.	4.31 in.	2 in.
84401	Square	1/2 in.-13	3.06 in.	5.31 in.	1.75 in.
84402	Square	1/2 in.-13	3.06 in.	6.31 in.	2 in.

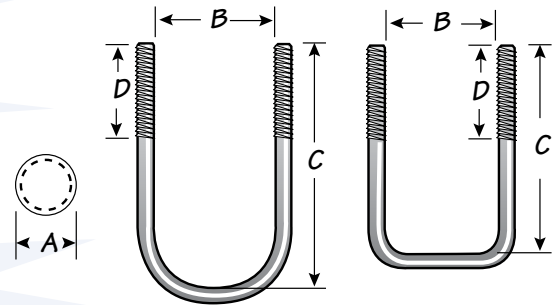

A = Rod/Thread Size B = Width (inside)
 C = Leg Length (inside) D = Thread Length

Finishes Available:

G - Galvanized Y - Yellow Zinc
 Z - Zinc Plate S - Stainless Steel

When ordering U-bolts be sure to include the finish by adding the coating letter to the end of the part number (83009G, 83009Y, 83009Z or 83009S).

FASTENERS

Part ID:	Type	Thread Size	Size	Finish
10627	Nyloc Nut	3/8 in.-16	--	Zinc
10014	Hex Nut	3/8 in.-16	--	Galvanized
10613	Top Lock, Hex Nut	1/2 in.-13	--	Galvanized
10645	Nyloc Nut	1/2 in.-13	--	Zinc
10649	Nyloc Nut	1/2 in.-20	--	Zinc
10688	Nyloc Nut	9/16 in.-18	--	Zinc
10696	Split Lock Washer	--	3/8 in.	Galvanized
10511	Split Lock Washer	--	1/2 in.	Galvanized



CUSTOM U-BOLTS

Let Tie Down answer your U-bolt needs with our high speed u-bolt production. Coiled rod to finished u-bolt in one process. Buy direct from the manufacturer and get U-bolts designed to your specifications.

Call 1-800-241-1806 for a customized u-bolt quote or use Tie Down's convenient U-Bolt Order Form.

BOW STANDS

BOW STANDS

Tie Down Engineering bow stands and winch mounts are hot dip Galvanized inside and out for lasting corrosion protection. Heavy gauge steel base is designed for a stable, strong, durable, and sturdy addition to your trailer line.

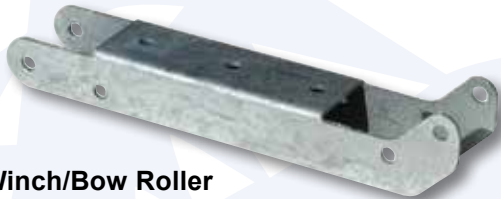

Winch/Bow Roller
Part ID: **43661**



Pontoon Winch Mount
Part ID: **43694**



2 x 4 Bow Stand
Part ID: **43589**

2 x 2 Bow Stand
Part ID: **43600**

Part ID:	Description	Tongue Width	Tube Size	Base Stand	Height	Angle	Gauge
43589	Bow Stand	3 in.	2 in. x 4 in.	5 in. x 12 in.	34.5 in.	25°	7
43599	Heavy Duty Bow Stand	3 in.	2 in. x 4 in.	5 in. x 12 in.	40 in.	25°	7
43585	Bow Stand	3 in.	3 in. x 5 in.	5 in. x 14 in.	36.56 in.	25°	9
43586	Extended Bow Stand	3 in.	3 in. x 5 in.	5 in. x 14 in.	58.25 in.	25°	9
43587	Bow Stand	3 in.	3 in. x 5 in.	5 in. x 14 in.	45.56 in.	25°	9
43525	Bow Stand	3 in.	2 in. x 3 in.	3 in. x 9 in.	26.24 in.	25°	11
43560	Bow Stand	3 in.	2 in. x 3 in.	5 in. x 8 in.	19.84 in.	35°	11
43575	Bow Stand	3 in.	3 in. x 3 in.	5 in. x 10 in.	23.36 in.	25°	11
43580	Bow Stand	3 in.	3 in. x 4 in.	5 in. x 10 in.	31.97 in.	25°	11
43581	Tall Bow Stand	3 in.	3 in. x 4 in.	5 in. x 10 in.	44.66 in.	25°	11
43583	Bow Stand	3 in.	3 in. x 3 in.	5 in. x 6 in.	23.36 in.	25°	11
43588	Bow Stand	3 in.	2 in. x 4 in.	5 in. x 12 in.	30 in.	25°	11
43590	Pontoon Trailer Bow Stand	3 in.	3 in. x 4 in.	5 in. x 10 in.	42 in.	90°	11
43604	Tall Bow Stand	2 in.	2 in. x 2 in.	4 in. x 6 in.	36.98 in.	30°	11
43608	Bow Stand	3 in.	3 in. x 3 in.	5 in. x 10 in.	31.19 in.	25°	11
43600	Bow Stand	2 in.	2 in. x 2 in.	4 in. x 6 in.	20.91 in.	30°	14

BOW STANDS

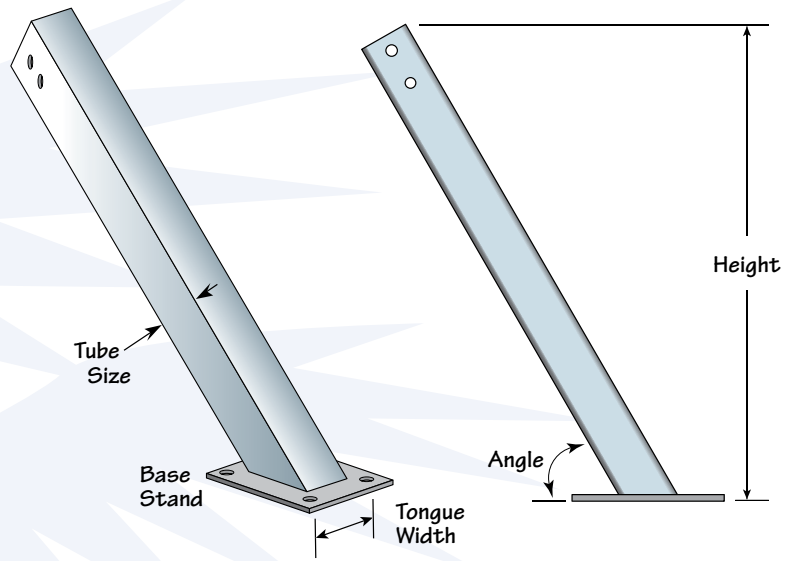

Bow Stand
 Part ID: **43589**
 Tube Size: 2 x 4
 Base Stand: 5 x 12
 Tongue Size: 3
 Gauge: 7

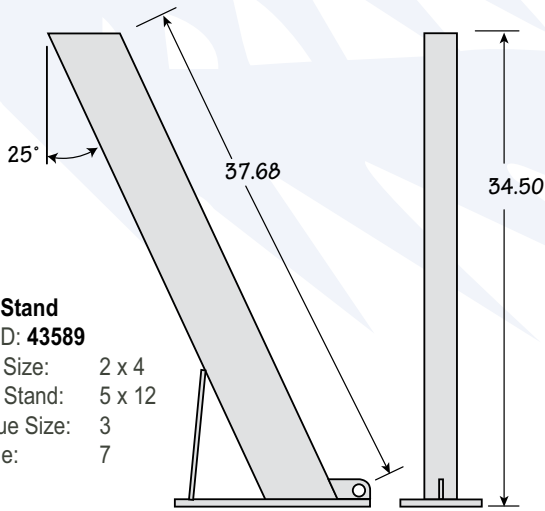

Bow Stand
 Part ID: **43599**
 Tube Size: 2 x 4
 Base Stand: 5 x 12
 Tongue Size: 3
 Gauge: 7

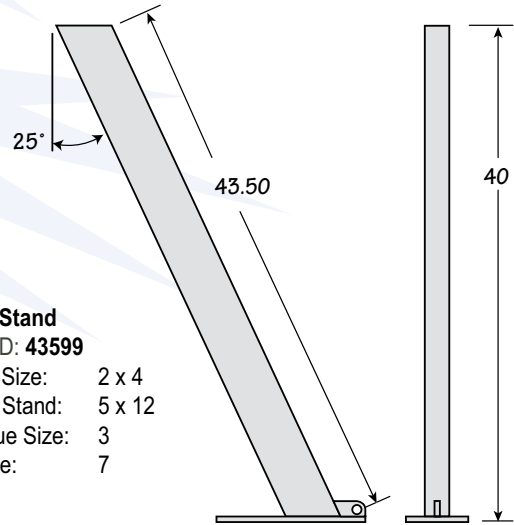

Bow Stand
 Part ID: **43585**
 Tube Size: 3 x 5
 Base Stand: 5 x 14
 Tongue Size: 3
 Gauge: 9

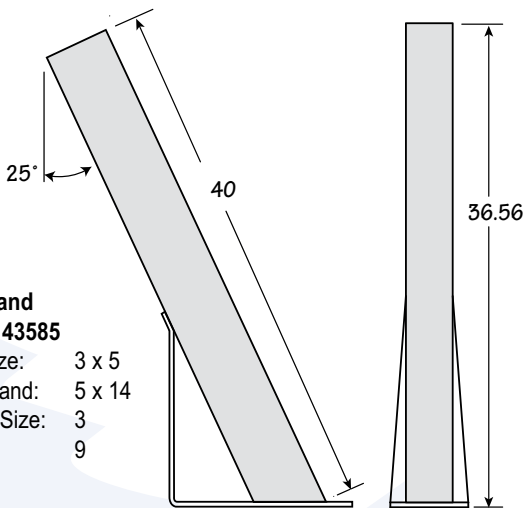

Extended Bow Stand
 Part ID: **43586**
 Tube Size: 3 x 5
 Base Stand: 5 x 14
 Tongue Size: 3
 Gauge: 9

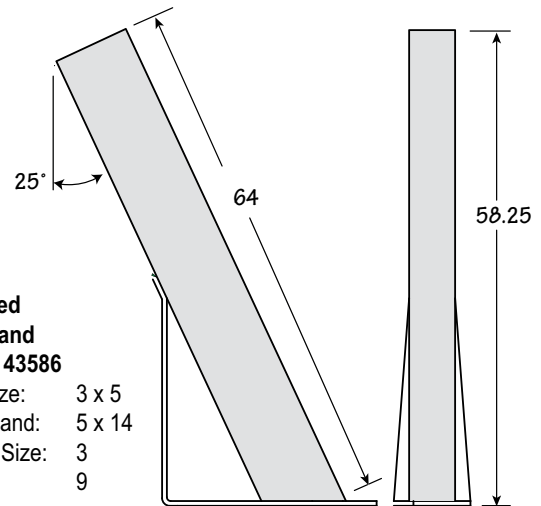

BOW STANDS

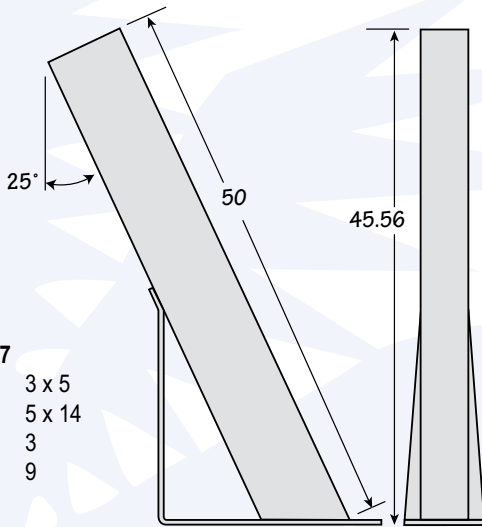

Bow Stand
 Part ID: 43587
 Tube Size: 3 x 5
 Base Stand: 5 x 14
 Tongue Size: 3
 Gauge: 9

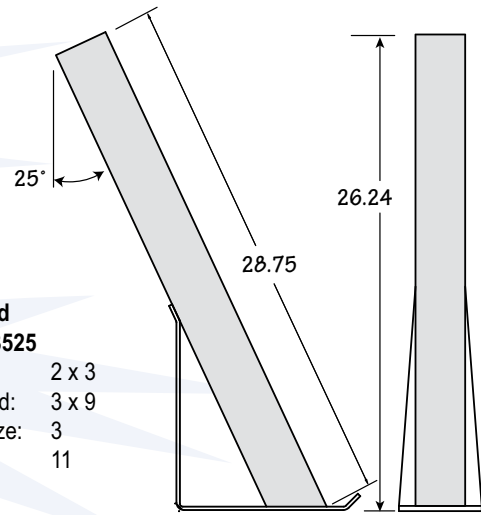

Bow Stand
 Part ID: 43525
 Tube Size: 2 x 3
 Base Stand: 3 x 9
 Tongue Size: 3
 Gauge: 11

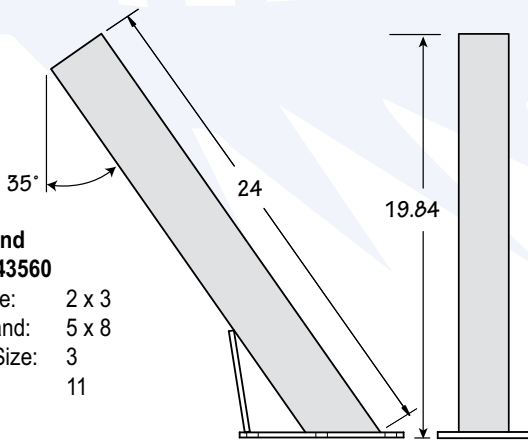

Bow Stand
 Part ID: 43560
 Tube Size: 2 x 3
 Base Stand: 5 x 8
 Tongue Size: 3
 Gauge: 11

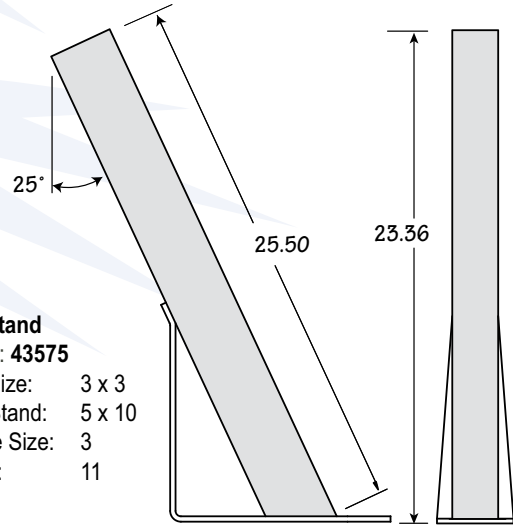

Bow Stand
 Part ID: 43575
 Tube Size: 3 x 3
 Base Stand: 5 x 10
 Tongue Size: 3
 Gauge: 11

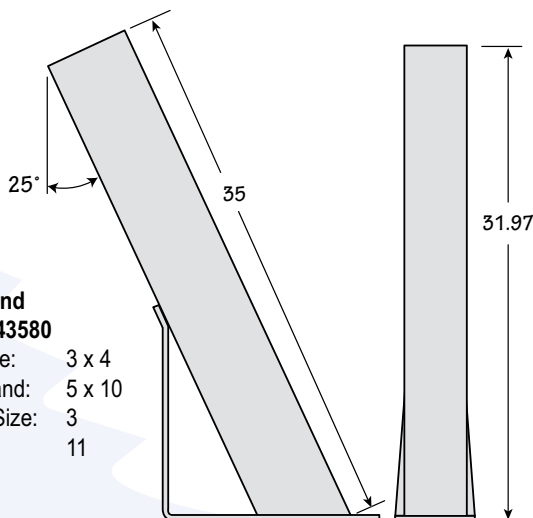

Bow Stand
 Part ID: 43580
 Tube Size: 3 x 4
 Base Stand: 5 x 10
 Tongue Size: 3
 Gauge: 11

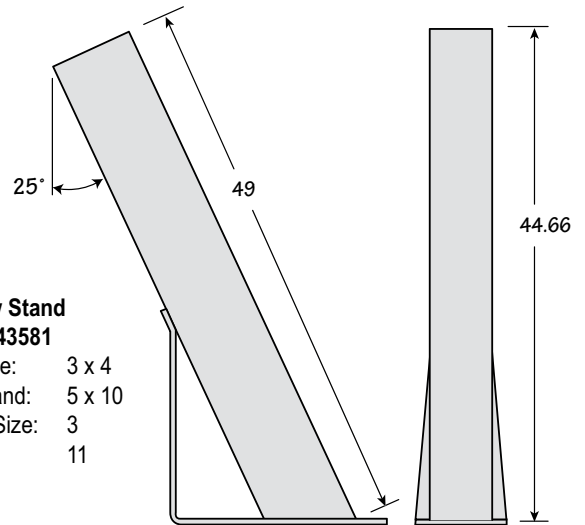

Tall Bow Stand
 Part ID: 43581
 Tube Size: 3 x 4
 Base Stand: 5 x 10
 Tongue Size: 3
 Gauge: 11

BOW STANDS

Bow Stand

Part ID: **43583**
 Tube Size: 3 x 3
 Base Stand: 5 x 6
 Tongue Size: 3
 Gauge: 11

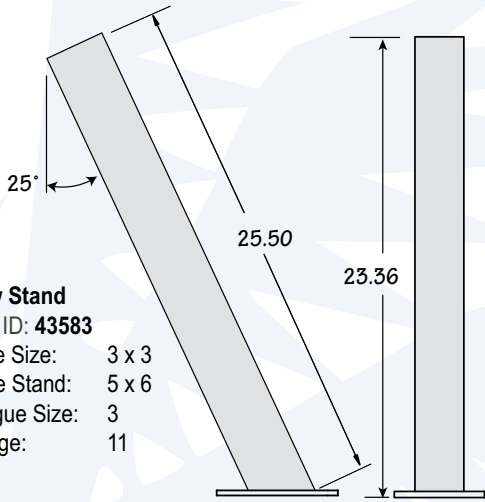

Bow Stand

Part ID: **43588**
 Tube Size: 2 x 4
 Base Stand: 5 x 12
 Tongue Size: 3
 Gauge: 11

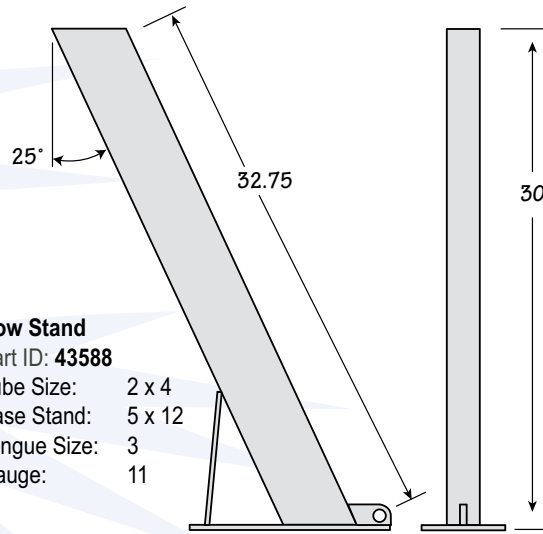

Pontoon Bow Stand

Part ID: **43590**
 Tube Size: 3 x 4
 Base Stand: 5 x 10
 Tongue Size: 3
 Gauge: 11

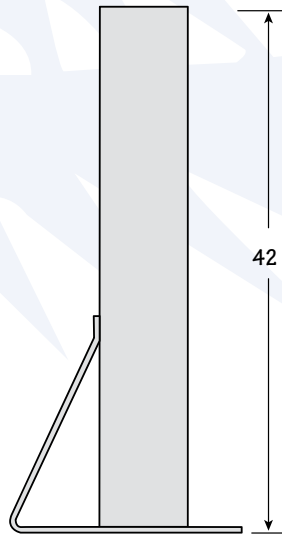

Tall Bow Stand

Part ID: **43604**
 Tube Size: 2 x 2
 Base Stand: 4 x 6
 Tongue Size: 2
 Gauge: 11

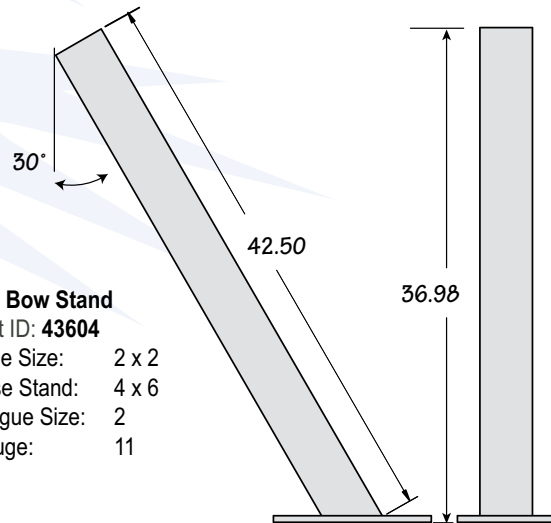

Bow Stand

Part ID: **43608**
 Tube Size: 3 x 3
 Base Stand: 5 x 10
 Tongue Size: 3
 Gauge: 11

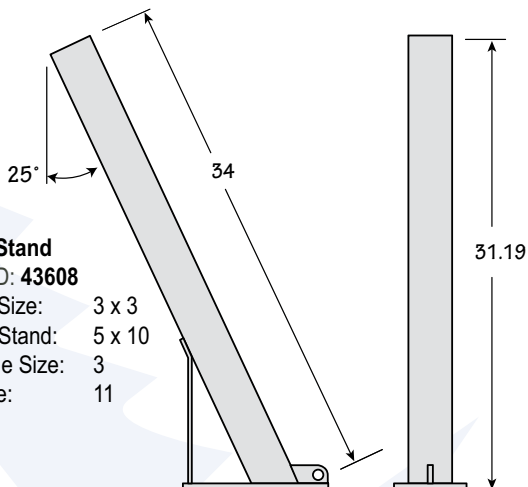

Bow Stand

Part ID: **43600**
 Tube Size: 2 x 2
 Base Stand: 4 x 6
 Tongue Size: 2
 Gauge: 14

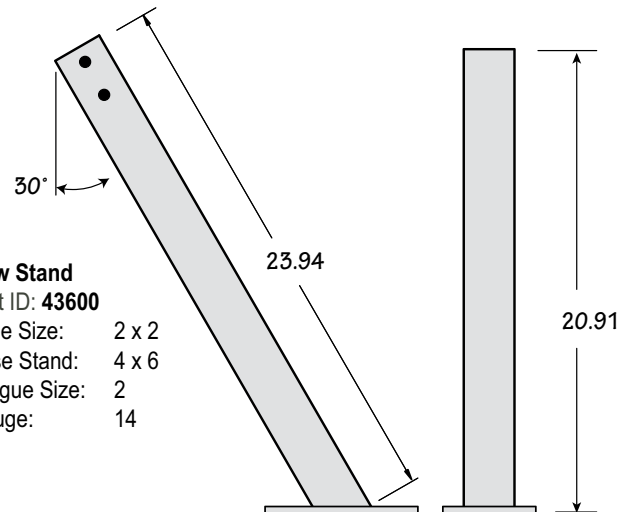

BOW STANDS

Part ID:	Description	Fits Tube Size	Length	Gauge
43624	Winch/Bow Roller Mount	2 in.	18.75 in.	8
43677	Tilt Winch Mount	3 in.	22.5 in.	8
43682	Winch Stop Bracket L & R	All	8.08 in.	8
43687	Pontoon Bow Stop Bracket	All	4.5 in.	8
43690	Pontoon Winch Mount	3 in.	18 in.	8
43694	Pontoon Winch Mount	3 in.	23 in.	8
43607	Jet Ski "Y" Stop	2 in.	9 in.	11
43661	Winch/Bow Roller Mount	2 in.	13.93 in.	11
43663	Winch Mount	2 in.	3.5 in.	11
43664	Winch/Bow Roller Mount	2 in.	17.94 in.	11
43666	Winch/Bow Roller Mount	2 in.	14.75 in.	11
43578	Winch/Bow Roller Mount	3 in.	16.30 in.	1/4
43627	Winch/Bow Roller Mount	2 in.	17.25 in.	1/4
43678	Winch/Bow Roller Mount	2 in.	22.13 in.	1/4
43679	Winch/Bow Roller Mount	3 in.	23.13 in.	1/4
43685	Winch Mount	3 in.	25 in.	1/4

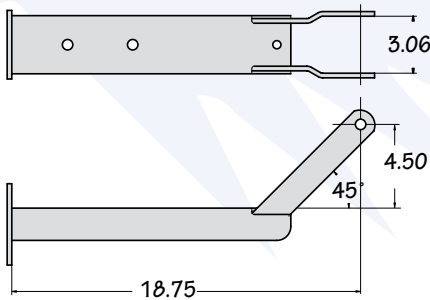

Winch/Bow Roller Mount Fits tube: 2
Part ID: 43624 Gauge: 8

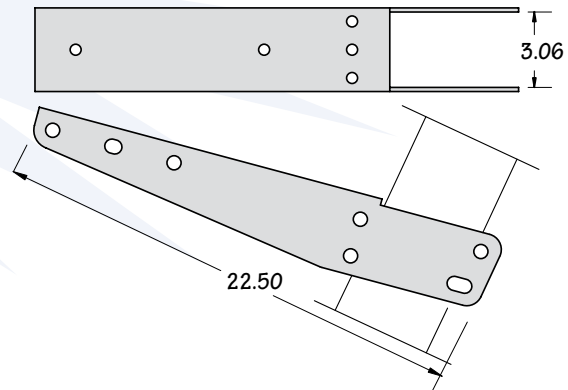

Tilt Winch Mount Fits tube: 3
Part ID: 43677 Gauge: 8

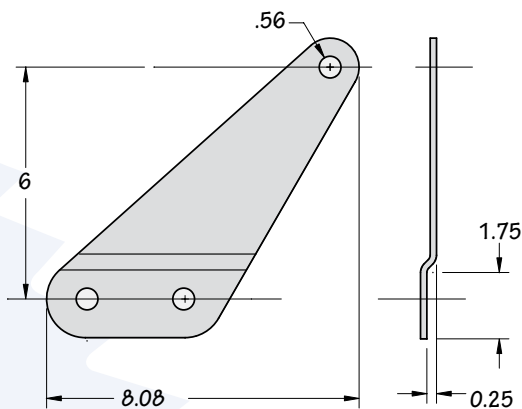

Bow Stop Bracket L & R Fits tube: All
Part ID: 43682 Gauge: 8

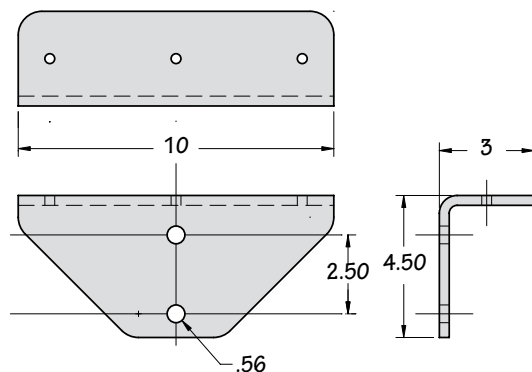

Pontoon Bow Stop Fits tube: All
Part ID: 43687 Gauge: 8

TIE DOWN BOW STANDS

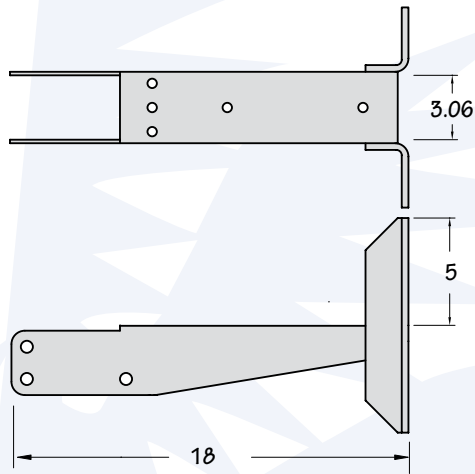

Pontoon Winch Mount Fits tube: 3
Part ID: 43690 Gauge: 8

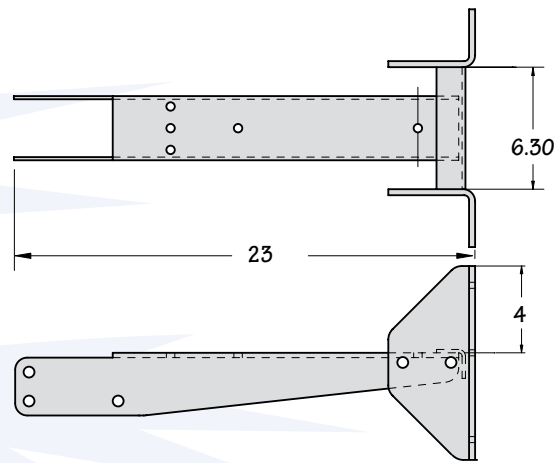

Pontoon Winch Mount Fits tube: 3
Part ID: 43694 Gauge: 8

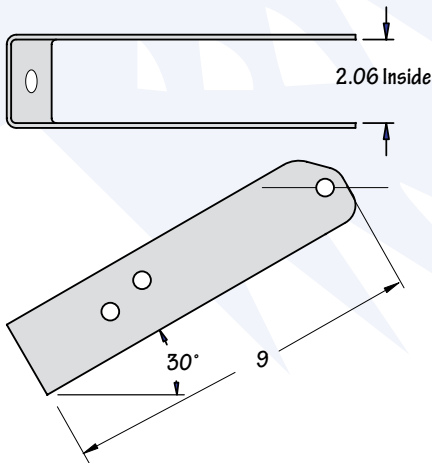

Jet Ski "Y" Stop Mount Fits tube: 2
Part ID: 43607 Gauge: 11

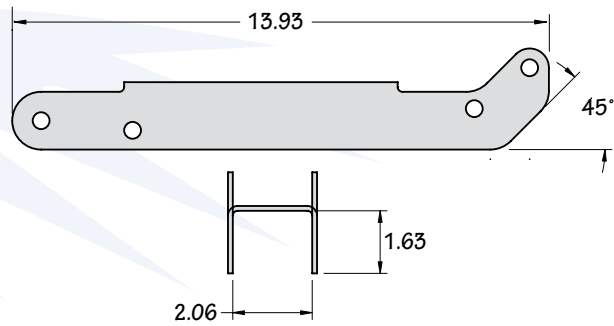

Winch/Bow Roller Mount Fits tube: 2
Part ID: 43661 Gauge: 11

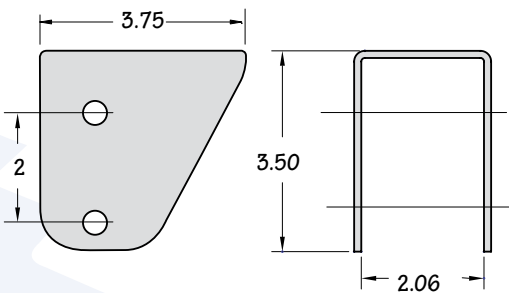

Winch Mount Fits tube: 2
Part ID: 43663 Gauge: 11

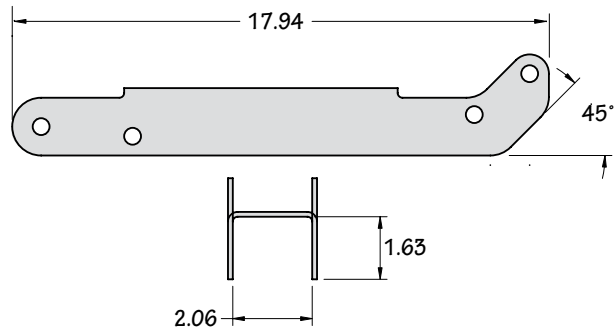

Winch/Bow Roller Mount Fits tube: 2
Part ID: 43664 Gauge: 11

BOW STANDS

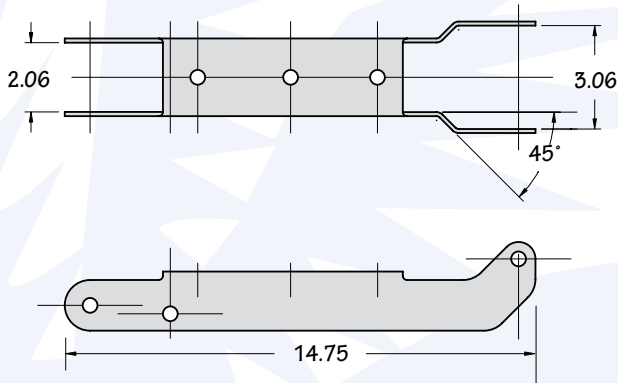

Winch/Bow Roller Mount Fits tube: 2
Part ID: 43666 Gauge: 11

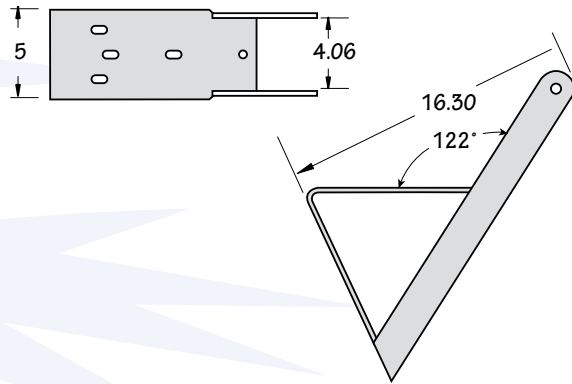

Winch/Bow Roller Mount Fits tube: 3
Part ID: 43578 Gauge: 1/4

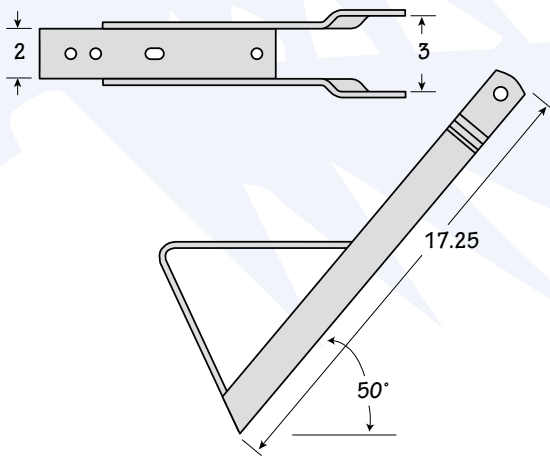

Winch/Bow Roller Mount Fits tube: 2
Part ID: 43627 Gauge: 1/4

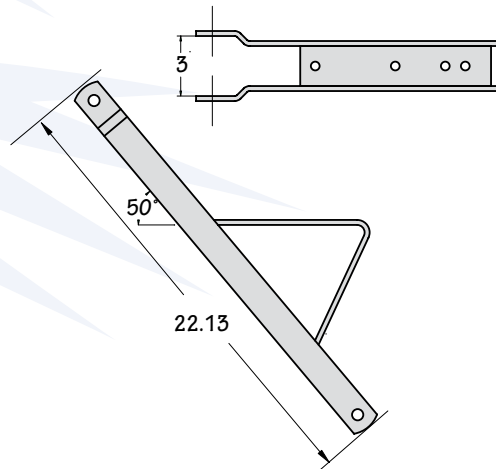

Winch/Bow Roller Mount Fits tube: 2
Part ID: 43678 Gauge: 1/4

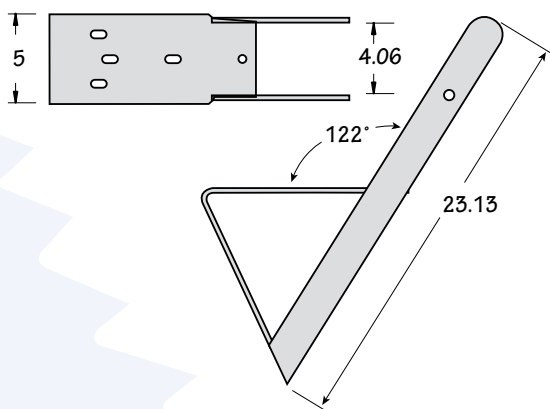

Winch/Bow Roller Mount Fits tube: 3
Part ID: 43679 Gauge: 1/4

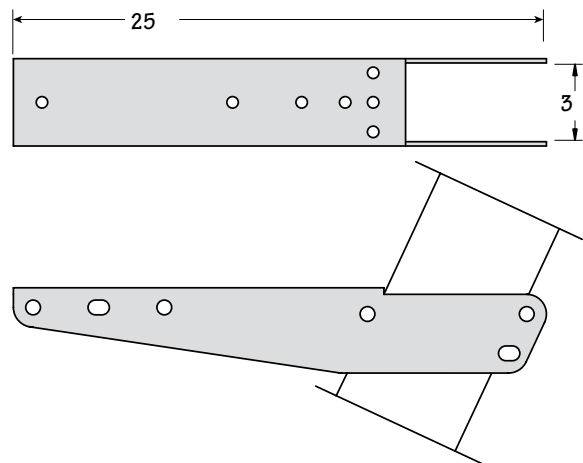

Winch Mount Fits tube: 3
Part ID: 43685 Gauge: 1/4

ADJUSTABLE ANGLE PWC/JON BOAT WINCH MOUNT

Fits 2 in. or 3 in. wide tongues, requires u-bolts and spring hangers as shown.

Part ID:	Description	Finish
43532	2 Piece PWC Winch Stand*	Raw
43532P	2 Piece PWC Winch Stand*	Black Powder Coat
43532G	2 Piece PWC Winch Stand*	Galvanized
43532PA	2 Piece PWC Winch Stand with Rollers**	Black Powder Coat
43532GA	2 Piece PWC Winch Stand with Rollers**	Galvanized

* Does not include rollers, u-bolts or hardware.

** Includes bow roller (#48654) and end bells (#48974) assembled.
U-bolts and mounting hardware not included.

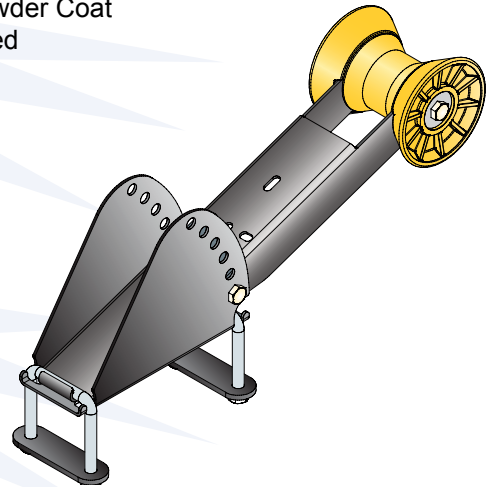

BOW STAND COMBINATIONS

2 in. x 2 in. x 14 ga. galvanized tube with 4 in. x 6 in. x 7 ga. base, winch mounts made of 11 ga. galvanized steel.

Part ID: **43661** Winch Mount
Part ID: **43600** Bow Stand

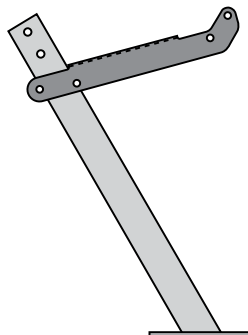

Part ID: **43663** Winch Mount
Part ID: **43607** "Y" Stop Mount
Part ID: **43600** Bow Stand

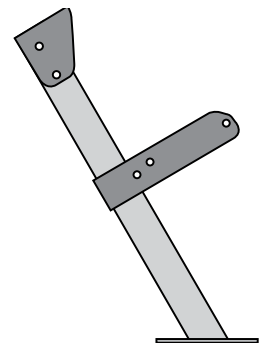

BOW STANDS

BOW STAND COMBINATIONS

2 in. x 2 in. x 14 ga. galvanized tube with 4 in. x 6 in. x 7 ga. base, winch mounts made of 11 ga. galvanized steel.

2 in. x 3 in. x 11 ga. galvanized tube, 1/4 in. galvanized winch mount

Part ID: **43678** Winch Mount

Part ID: **43525** Bow Stand

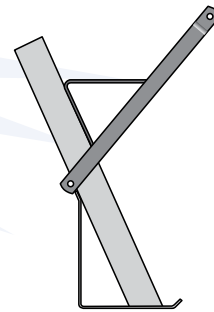

4 in. x 3 in. x 11 ga. galvanized tube, 1/4 in. galvanized base & 8 ga. brackets

Part ID: **43677** Winch Mount

Part ID: **43682** Bow Stop Bracket

Part ID: **43580** Bow Stand

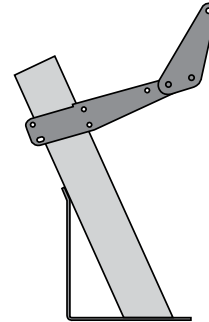

Pontoon Trailer Bow Stand 11 ga. galvanized tube, 1/4 in. galvanized winch mount & 8 ga. bracket

Part ID: **43690** Winch Mount

Part ID: **43590** Bow Stand

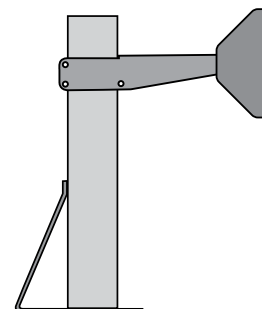

BOW/WINCH MOUNTS

- ~ Dual bow chain hook points: base and winch mount
- ~ Laser cut lower bow chain connector (No "chain link")
- ~ Heavy duty black vinyl top cap installed
- ~ Designed for 3 in. wide tongues
- ~ Hot Dip Galvanized
- ~ Galvanized U-bolts



**42 in. HD Combo
Stand & Mount**

Part ID: **43589A**

36 IN. COMBO STAND & MOUNT

Assembly includes:
2 in. x 4 in. x 11 ga. 30 in. Bow Stand #43588
Winch Mount #43679
2 x 4 Vinyl Top Cap.

Part ID: **43588R** - with 4 in. Amber End Bells Installed
Part ID: **43588A** - End Bells not included



Hull Sav'r Bow Roller with
End Bells Installed on
#43588R, #43589R and 43599R

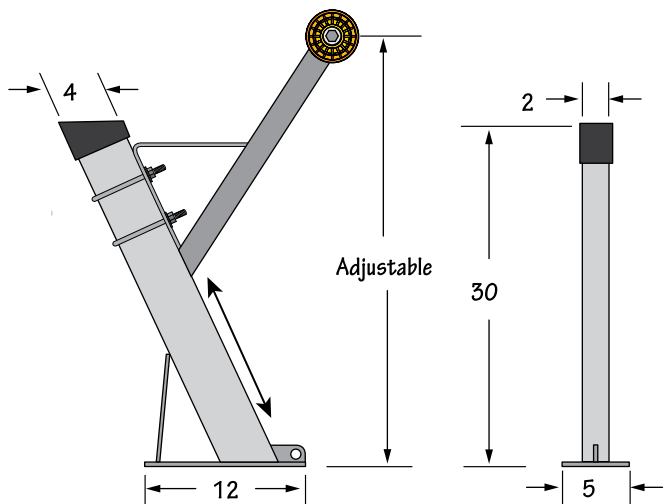

BOW STANDS

42 IN. HD COMBO STAND & MOUNT

Assembly includes:
2 in. x 4 in. x 7 ga. 34.5 in. Bow Stand #43589
Winch Mount #43679
2 x 4 Vinyl Top Cap

Part ID: **43589R** - with 4" Amber End Bells Installed
Part ID: **43589A** - End Bells not included

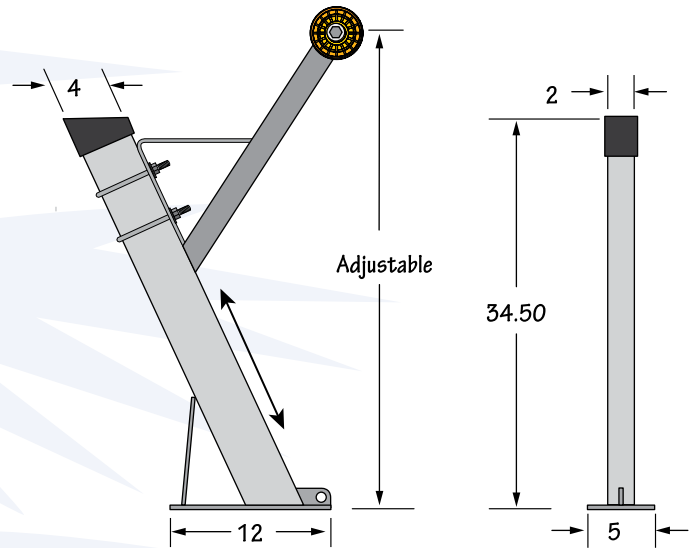

46" IN. COMBO STAND & MOUNT

Assembly includes:
2 in. x 4 in. x 1/4 ga. 40 in. Bow Stand #43599
Winch Mount #43578
2 x 4 Vinyl Top Cap

Part ID: **43599A** - with 4 in. Amber End Bells Installed
Part ID: **43599R** - End Bells not included

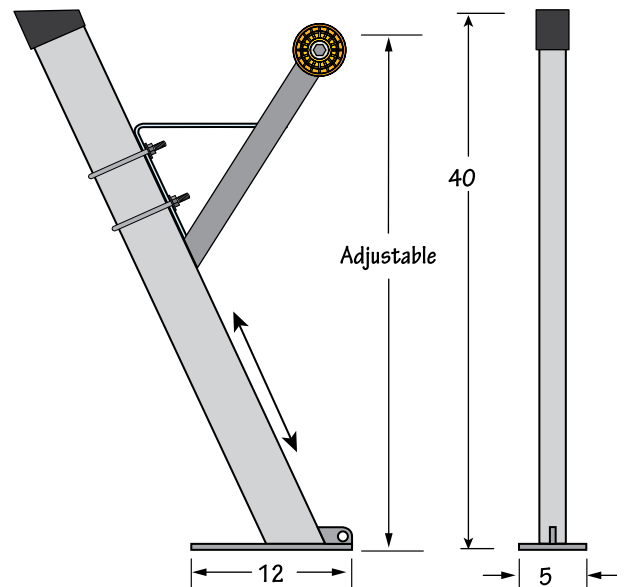

TIE DOWN FRAME COMPONENTS

FRAME RAILS

Tie Down has 9 tube lasers available to manufacture custom frame components including frame rails. Our goal is to assist in helping you streamline production and increase quality. Additionally, we have several CNC controlled tube bending machines if required. Please contract us for more information.

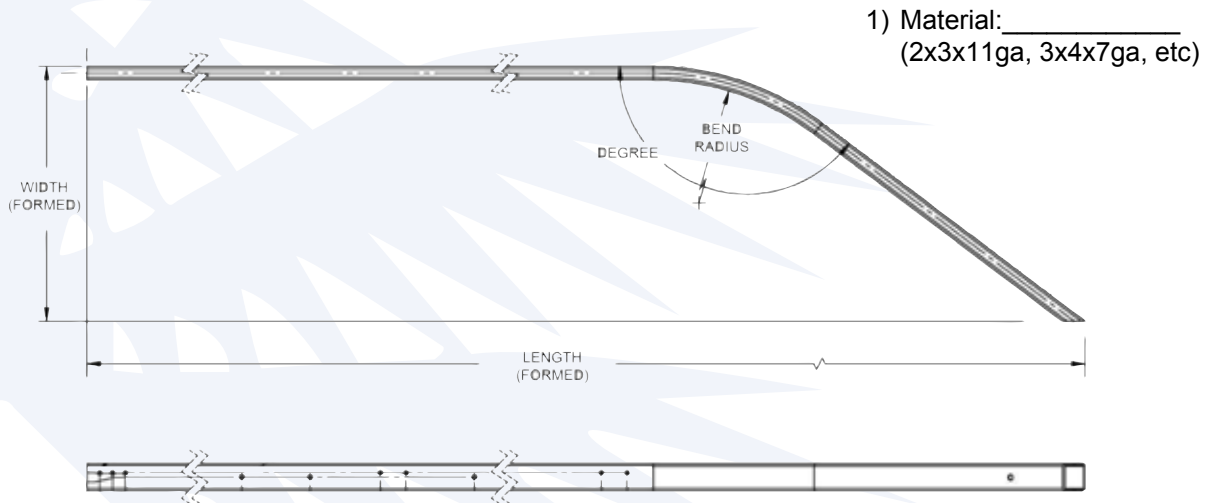

CROSSMEMBERS

Tie Down has 9 tube lasers available to manufacture custom frame components including crossmembers. Our goal is to assist in helping you streamline production and increase quality. Additionally, we have several CNC controlled tube bending machines if required. Please contract us for more information.

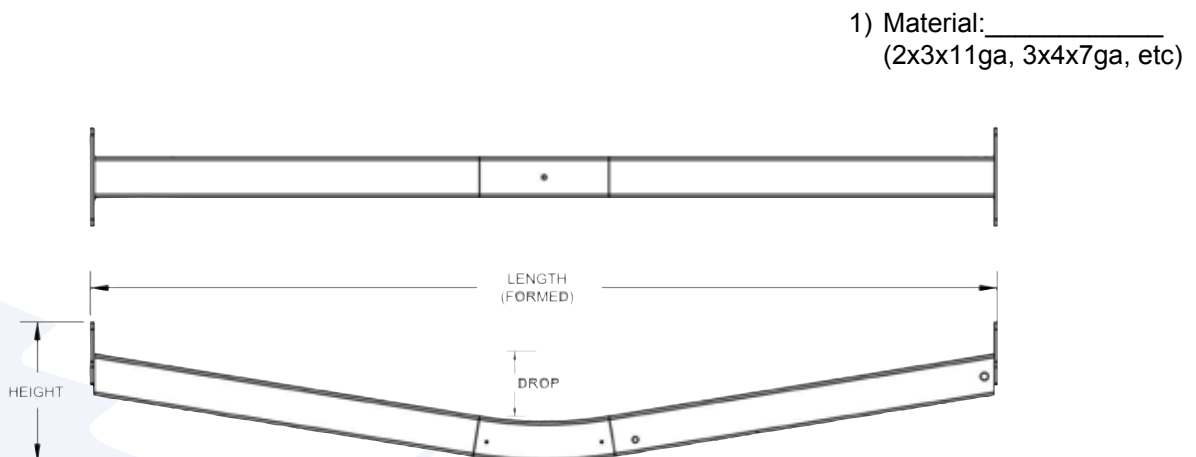

FRAME COMPONENTS

TONGUES & SWING TONGUES

Tie Down offers many tongue options, including full assemblies, individual components, or part kits. Please browse through our popular options below and contact us with any questions.

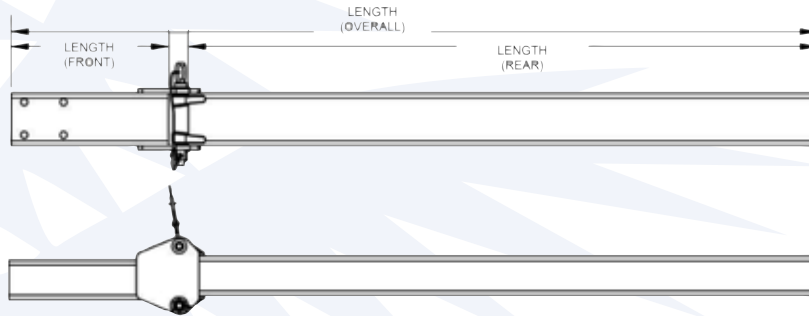

CAST SWING TONGUE KIT

Kit includes (1) cast pivot box, (2) hinge plates, (1) pivot bolt with Zerc fitting, (1) pull pin with cable lanyard, (1) nyloc nut, and (2) washers. Cast swing tongue kits are designed to accommodate 7 gauge - 11 gauge tube wall thickness in either 3x3, 3x4, or 3x5 tube profiles.

Part ID	Tube Size	Capacity
17075A	3x3"	7,500 lbs
17073A	3x4"	8,500 lbs
17076A	3x5"	8,500 lbs



Part ID	Description
17075	3x3 Cast Pivot Box (1)
17073	3x4 Cast Pivot Box (1)
17076	3x5 Cast Pivot Box (1)
48917	Hinge Plate (1)
10726	3x3 Hardware Kit (Pull Pin, Pivot Bolt, Nyloc, Washers)
10727	3x4 Hardware Kit (Pull Pin, Pivot Bolt, Nyloc, Washers)
10728	3x5 Hardware Kit (Pull Pin, Pivot Bolt, Nyloc, Washers)
70509A	"T" Handle Pull Pin - 3"
70512A	"T" Handle Pull Pin - 4"
70513A	"T" Handle Pull Pin - 5"
10497A	Pull Pin - 3" with Lanyard
10498A	Pull Pin - 4" with Lanyard
10495A	Pull Pin - 5" with Lanyard
10592A	Pull Pin - 3" (5/8") Grade 8
10593A	Pull Pin - 4" (5/8") Grade 8
10695	Pull Pin - 5" (5/8") Grade 8



TIE DOWN GUIDE ON'S & ACCESSORIES

BOAT SIDE GUIDES

PONTOON GUIDE POST

Bright orange end caps on these PVC guides give you a brighter target when loading your pontoon boat. The guide posts are designed to be mounted between the pontoons. Made of 1-1/4 in. square, 21 in. galvanized tube and covered by a 2 in. x 23.70 in. PVC pipe. Mounts to trailer cross members up to 3 in. wide.

Part ID: **48946A**

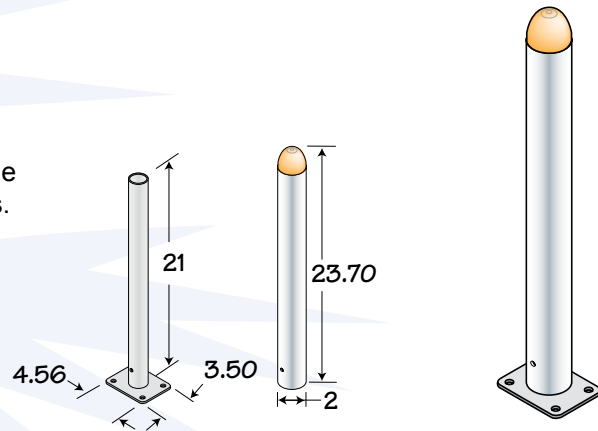

PONTOON TRAILER GUIDE ON'S

Bright orange end caps on these PVC guides give you a brighter target when loading your pontoon boat. The guide posts are designed to be mounted between the pontoons. Made of 1-1/2 in. square, 16 ga. steel tubing and covered by a 2 in. x 20 in. PVC pipe. Hot dip galvanized guide posts extend fully into the PVC tube for additional strength. Mounts to 2 in. trailer cross members (sold in pairs).

Part ID: **86465B**



HIGH IMPACT PONTOON TRAILER GUIDE ON'S

Ideal for larger pontoon boats. These guides are designed for rough water loading where high impact guides are required. The guide posts are hot dip galvanized for long life with covers made from high impact non-marking molded PVC. The guide posts are designed to be mounted between the pontoons. Made of 2-1/2 in. square, 13 ga. steel tubing. Mounts to trailer cross members up to 2 in. wide by 2 in. high (sold in pairs).

Part ID: **86467B**



GUIDE ON'S & ACCESSORIES

LOW RIDER GUIDE ON'S

Ideal for jon boats, bass boats and personal watercraft. The guide posts are hot dip galvanized for long life with covers made from high impact non-marking molded PVC. Low Rider Guide On's give you the extra advantage of high strength and great looks for your trailer. Made of 1-1/2 in. square, 16 ga. steel tubing and covered with wrap around protective PVC molded covers. Mounts to trailer cross members 2 in. x 2 in. and 2 in. x 3 in. frames. (sold in pairs).

Part ID: **86466B**



SIDE GUIDE

Trailer side guide 24 in. high. Made from heavy duty 2 in. wide x 3/8 in. hot dipped galvanized steel.

Part ID: **48065**

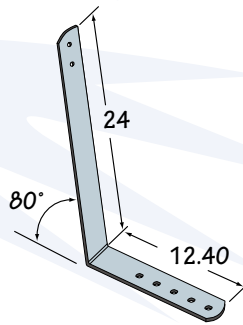

BOW GUIDE ASSEMBLY

Front bow guide is 48 in. wide, made from galvanized 2 in. x 2 in. tube, assembled with an amber PVC cover. Height is adjustable. Uses the 48091 bracket as shown on the 48103A one page 29 (#5) Weldment and cover also sold separately.

Guide with Cover (Assembly)

Part ID: **48084AG**

Weldment Only

Part ID: **48084G**

PVC 48" Cover

Part ID: **48367**

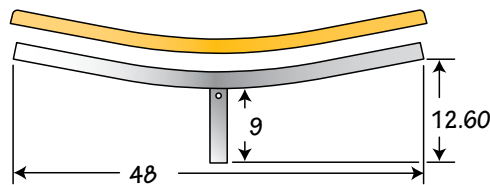

GUIDE ON'S & ACCESSORIES

BOW GUIDE ASSEMBLY

Includes everything listed below.

Part ID: **48103A**

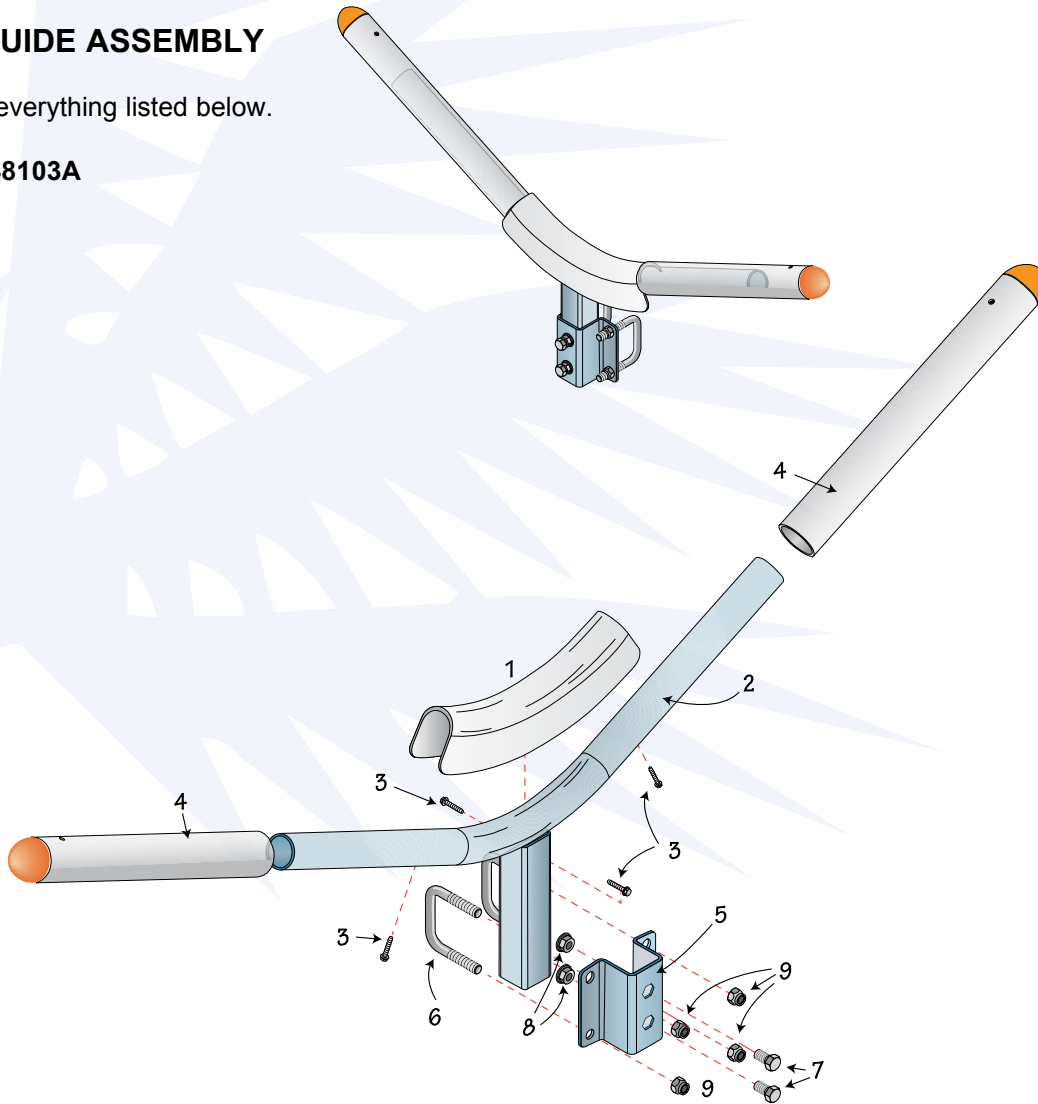

Item	Qty.	Part ID	Description
1	1	48350	Bow Guide PVC Cover
2	1	48103	Bow Guide, Weldment
3	4	10673	Plain Indented Hex Washer Head Tapping Screw
4	2	48104	18 in. PVC with end cap
5	1	48091	2 in. Channel Bracket
6	2	84420Z	U-bolt 1/2 in. -13 x 3.06 in. x 3.25 in.
7	2	10016	Hex Bolt 1/2 in.
8	2	10519	Flanged Hex Nut 1/2 in.
9	4	10645	Nyloc Hex Nut 1/2 in.

BRACKETS

GALVANIZED CHANNEL BRACKETS

- 2 in. Channel Bracket, 5 in. x 5.45 in., 7 ga. Galvanized Steel
- 2 in. Channel Bracket with Hex, 5 in. x 5.45 in., 7 ga. Galvanized Steel
- 1-1/2 in. Channel Bracket with Hex, 5 in. x 5 in., 7 ga. Galvanized Steel
- 1/2 in. Flange Nut

- Part ID: **48082**
- Part ID: **48091**
- Part ID: **48094**
- Part ID: **10519**

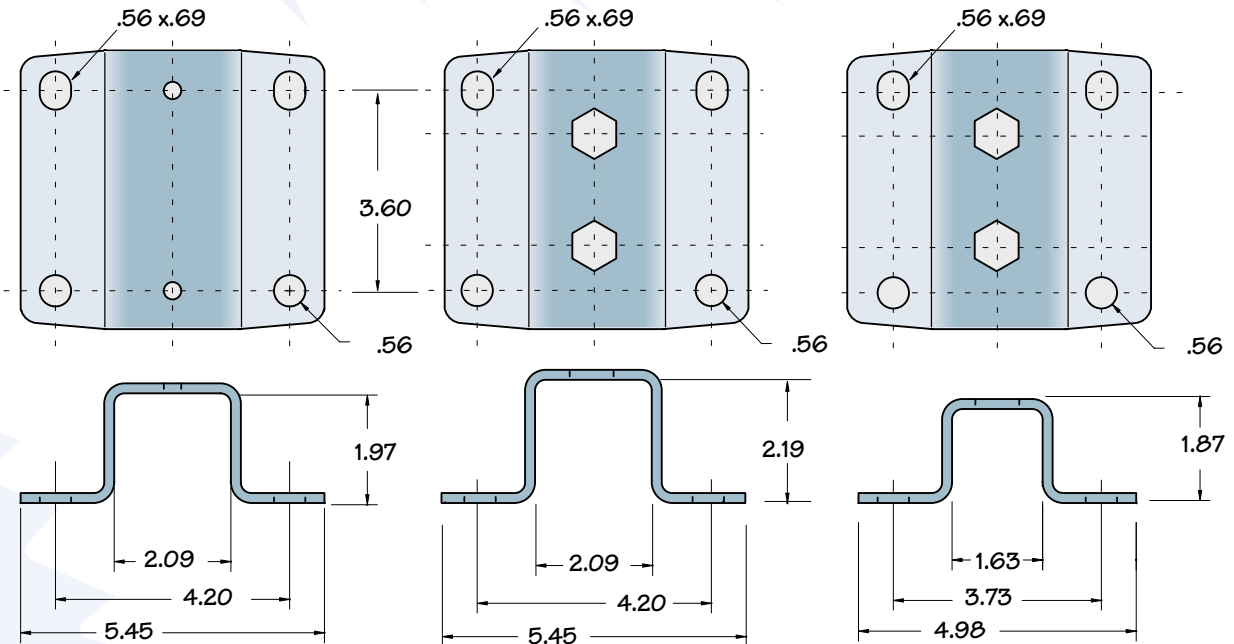
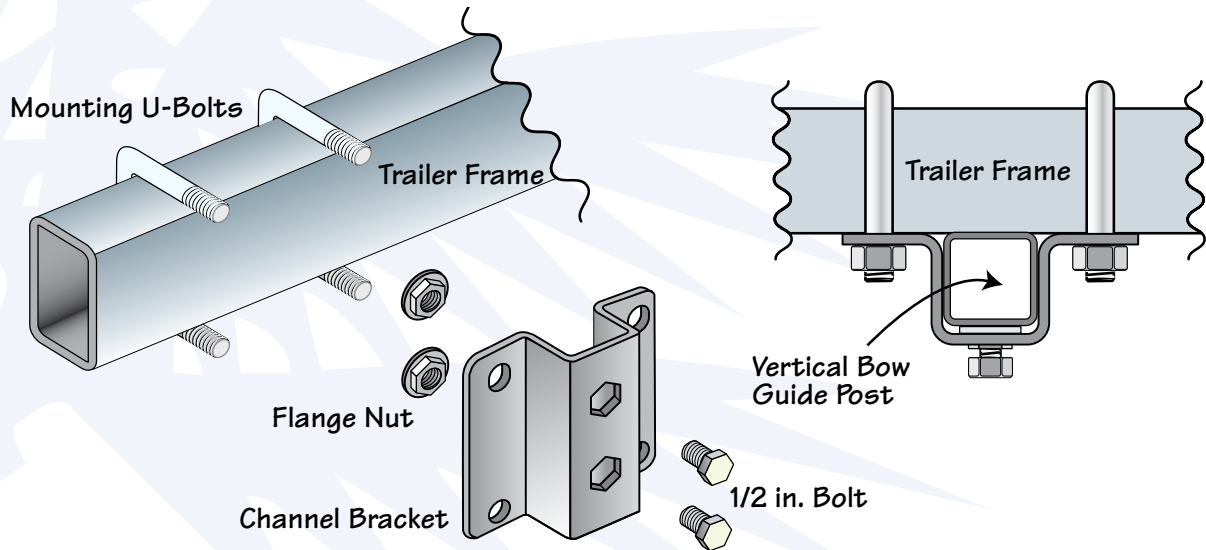

Part ID: **48082**

Part ID: **48091**

Part ID: **48094**

BRACKETS

Customize the look of your pontoon trailer with our versatile pontoon bunk brackets, produced from 11 ga. steel.

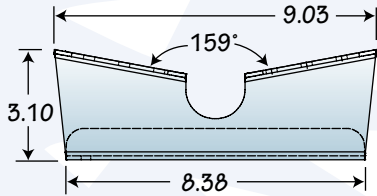

Part ID: **44870**

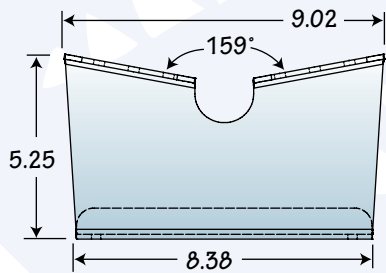

Part ID: **44879**

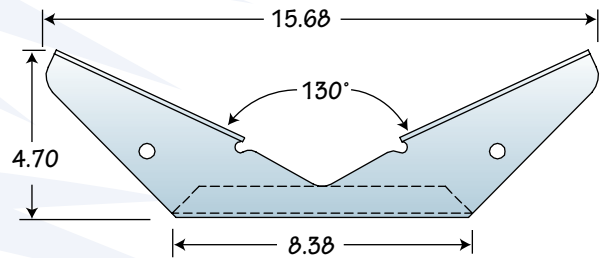

Part ID: **44012**

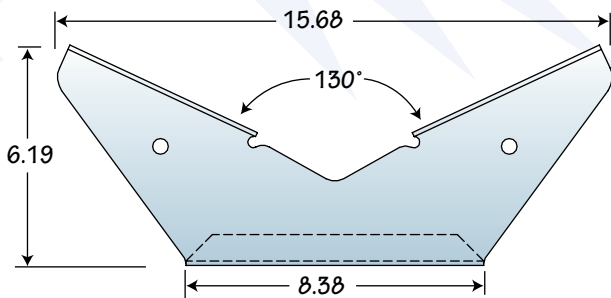

Part ID: **44004 Tall**

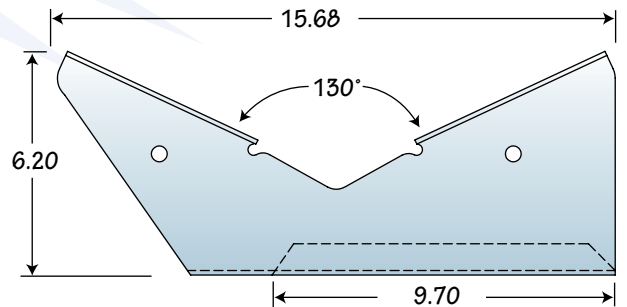

Part ID: **44050 Offset**

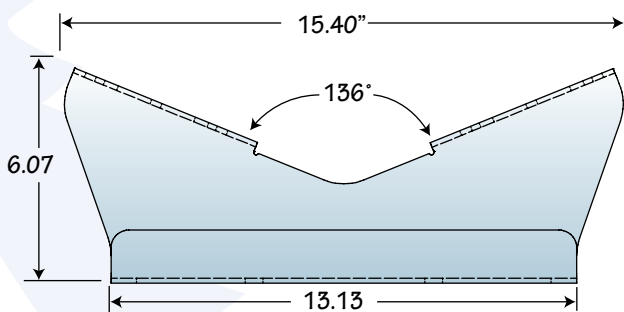

Part ID: **43747 Heavy Duty**
Mounts on top or under 2 in. rails

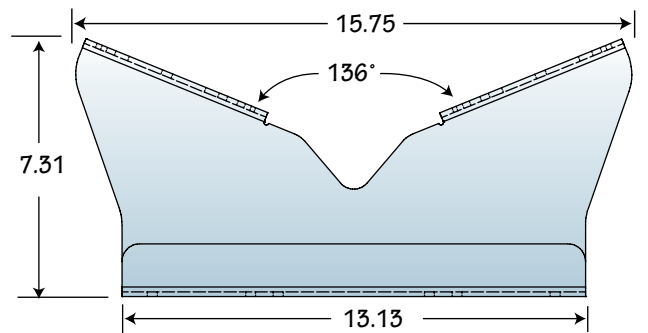

Part ID: **44830G**

BRACKETS

HEAVY DUTY VERTICAL BRACKETS

- Great for aluminum trailers
- Heavy duty 1/4 in. steel brackets are hot dip galvanized for lasting corrosion protection
- 1/4 in. heavy duty steel, 5 in. wide
- Four different heights to work with your application

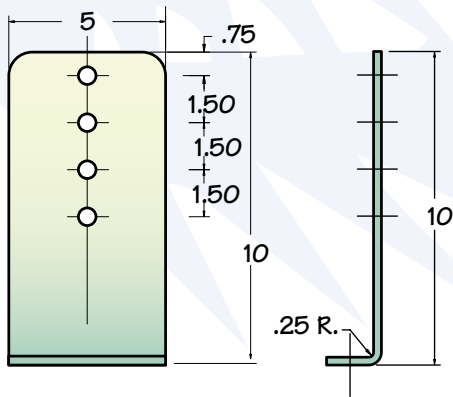

Part ID: 44091G

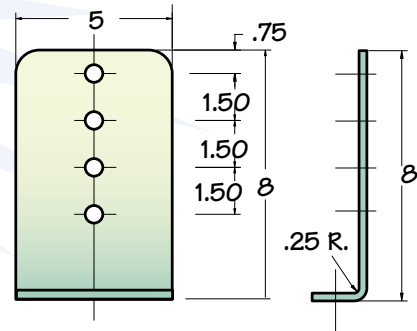

Part ID: 44090G

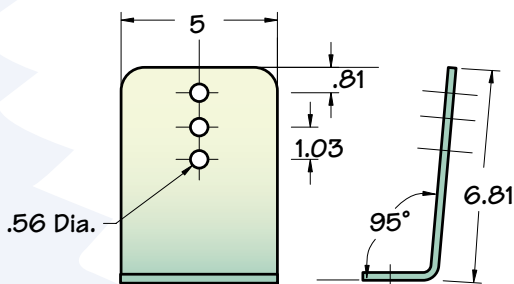

Part ID: 44037

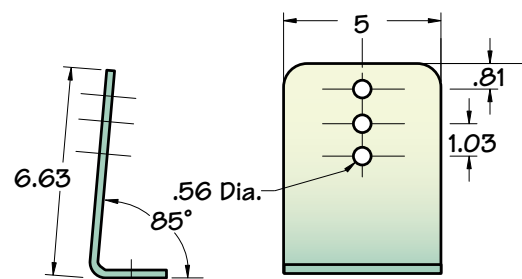

Part ID: 44036

BUNK BRACKETS

Heavy 11 ga. hot dip galvanized steel brackets mount 2 in. bunks on edge. Slotted for vertical adjustment to standard or deep-V hulls.

Part ID:	A	B	C	Slot Length
86149	8.00	2.00	1.50	4.50
86125G	9.50	2.00	1.50	6.00
86126G	12.63	2.00	1.50	9.13

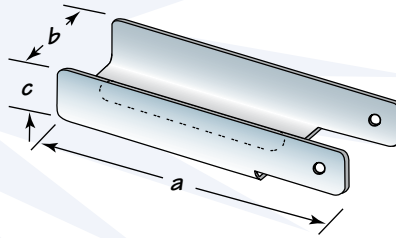

BUNK BRACKET

Slim design vertical bunk bracket with non-slip dimples. Made from heavy duty 11 ga. steel.

Part ID: 44082

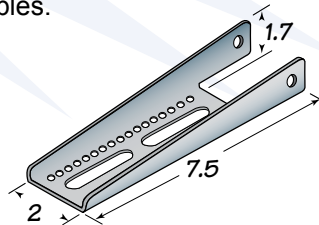

PWC BUNK BRACKETS

The innovative design of this light duty bolster bracket allows for bunk angle adjustment without the use of a swivel bracket. Great for use on PWC and skiff trailers. Made from heavy duty 11 ga. steel. Sold in pairs (L & R).

Part ID: 44009

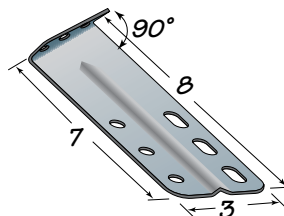

BRACKETS

HEAVY DUTY BUNK BRACKET

Made from 8 ga. steel, can be used with swivel brackets to provide the ultimate load capacity for your trailers. Sold in pairs (L & R).

Part ID:	A	B	C	Slot Length
86135	10.00	1.18	3.56	3.06
86134	12.00	1.18	3.56	3.06

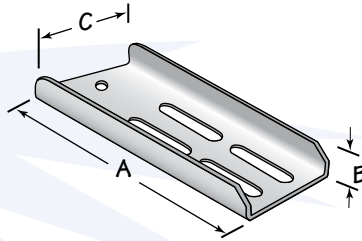

BOLSTER BRACKETS

Bolster brackets are designed to support bolster or bunk boards. Slotted for vertical adjustment and feature non-slip dimples to avoid movement and increase load capacity.

Part ID:	A	B	C	Slot Length
86130G	8.00	1.06	2.50	2.69
86131G	10.00	1.06	2.50	2.69
86132G	12.00	1.06	2.50	2.69
44056	14.00	1.06	2.50	2.69

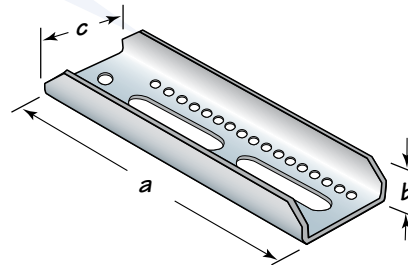

SWIVEL BRACKETS

Use with adjustable bolster brackets for proper angle of bunk or bolster boards.

Part ID:	A	B	C	D
86115G	3.50	1.25	2.00	0.53
86116	3.50	1.25	2.00	0.44
44006	3.75	1.50	2.00	0.53

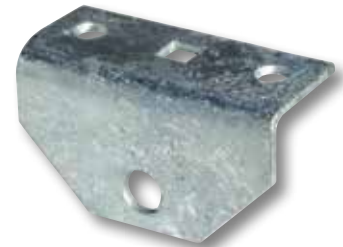
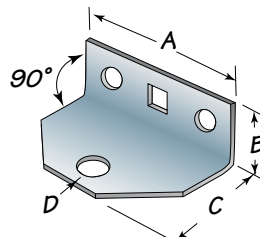

TAIL LIGHT BRACKET

Tail light bracket is produced from 16 ga. galvanized steel for long lasting durability.

Part ID: **44705**

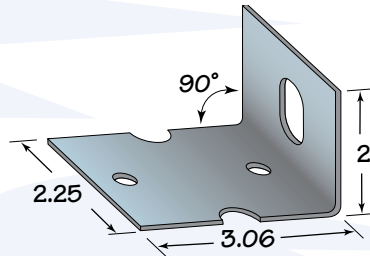

UNIVERSAL TAIL LIGHT BRACKET

Tail light bracket is produced from 7 ga. galvanized steel for long lasting durability.

Part ID: **44710**

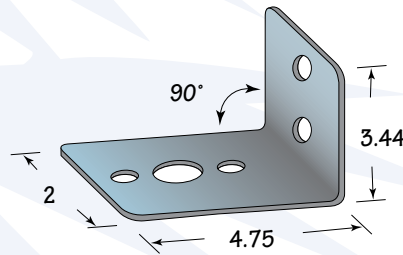

TONGUE SKID

Tongue skid produced from heavy duty 5 ga. galvanized steel.

Part ID: **46600**

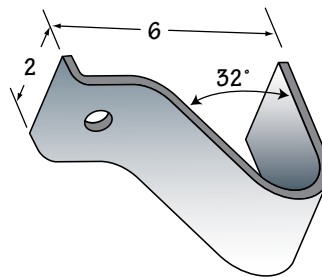

4" FRAME TIE DOWN

Bracket used with ratchet straps, 7 ga.

Part ID: **44650**

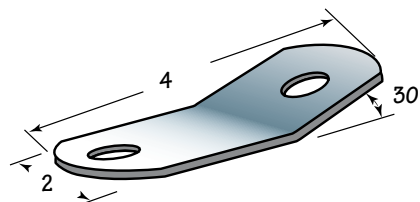

ROLLERS & BUNK SLICKS

Poly vinyl rollers are long lasting, will absorb shock, are cut resistant and will not mark or mar your boat. Tie Down's enhanced PVC formula far outperforms traditional polyurethane products.



ROLLERS & BUNK SLICKS

Description	Amber Part ID:	Black Part ID:	Shaft Size (in.)
Keel Roller 4 in., spool type	48374	48720	5/8
Keel Roller 5 in, spool type	48373	48722	5/8
Keel Roller 5 in, center type	48376	48721	5/8
Keel Roller 8 in	48377	48389	5/8
Keel Roller 10 in	48378	48723	5/8
Keel Roller 12 in	48379	48724	5/8
Bow Roller 3 in	48653	48381	1/2
Bow Roller 4 in	48651	48716	1/2
Bow Roller 3 in	48673	N/A	1/2
Bow Roller 3 in, use with 48770/48398	48771	48391	1/2
End Bell 3 in, for 48653/48381	48654	48669	1/2
End Bell 4 in, for 48651/48716	48652	48717	1/2
End Bell "Notched" 4 in	48674	N/A	1/2
End Cap 3.50 in, for 8 in, 10 in, 12 in Keel Rollers	48358	48725	5/8
End Cap "Notched" 3 in, use with 48771/48391	48770	48398	1/2
Wobble Roller 4 in, ribbed	46436	N/A	1.15
Wobble Roller 4 in, smooth	N/A	46437	3/4
Wobble Roller 5 in	48662	48719	7/8 & 1.15
Roller 2.50 in x 2 in, smooth surface	48665	N/A	1/2
Roller 4 in x 2.75 in, smooth surface	48666	N/A	5/8
"V" Bow Stop Block, 2 in	N/A	46438	3/8
"V" Bow Stop Block, 3 in	48372	48726	1/2
"V" Bow Stop Block, 4 in	N/A	46439	1/2
End Cap 2 in x 2 in	48363	N/A	N/A
Post Cap 3 in x 3 in	48375	N/A	N/A
Post Cap 4 in x 3 in	48368	N/A	N/A
Keel Pad 2 in x 12 in, fits 1.50 in cross beams	48675	N/A	N/A
Keel Pad 3.50 in x 15 in, fits 3 in cross beams	48650	48382	N/A
Keel Pad for 2500/3700# torsion axles	48663	N/A	N/A
Pontoon Step Pad, 17.12 in x 3.50 in.	43632-10A	43632-10	N/A

Bunk Glides/Slicks	Black Part ID:	White Part ID:	Fits
Bunk Glide On's, 2 in. x 4 in. x 4 ft., (sold in pairs, left & right)	86004	86002	4 in. Boards
Self Centering Bunk Glide On's, Modular 1 ft. End Section	46964	46964W	6 in. Boards
Self Centering Bunk Glide On's, Modular 2 ft. End Section	46965	N/A	6 in. Boards
Self Centering Bunk Glide On's, Modular 3 ft. Center Section	46966	46966W	6 in. Boards
Bunk Slick 1.75 in. x 17 in.	48668	N/A	4 in. Boards
Bunk Slick 3 in. x 16 in.	48667	N/A	6 in. Boards

Additional Products	Part ID:	Size
Bushing 7/8 in. ID, fits 5 in. Wobble Rollers (White only)	48369	7/8 in. ID
Bushing 1.15 in. ID, fits 5 in. Wobble Rollers (White only)	48370	1.15 in. ID
Keyed Roller Washer	45021	1.15 in. ID
Roller Washer 2 in.	45020	7/8 in. ID
PVC End Cap (fits 2 in. PVC pipe, White only)	48353	2 in. PVC Pipe
PVC End Cap (fits 2 in. PVC pipe, Orange only)	48353F	2 in. PVC Pipe
Isolation Pad - for cross members, Amber, 7.68 in. x 3.81 in.	46967	N/A
Wiring Harness Storage Saddle, Black, 4.38 in. x 2 in.	43643	N/A

ROLLERS & BUNK SLICKS

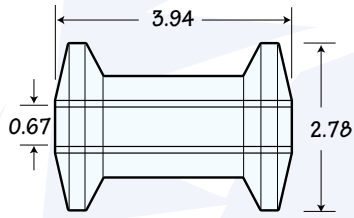

Keel Roller 4 in.
Part ID: **48374/48720**

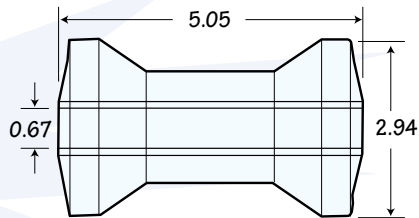

Keel Roller 5 in.
Part ID: **48373/48722**

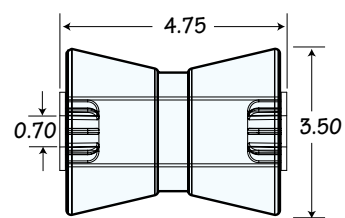

Keel Roller 4.5 in.
Part ID: **48376/48721**

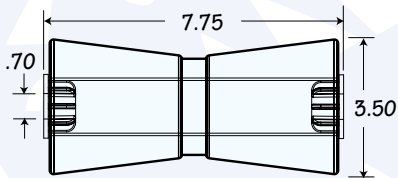

Keel Roller 8 in.
Part ID: **48377/48389**

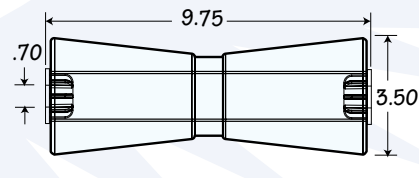

Keel Roller 10 in.
Part ID: **48378/48723**

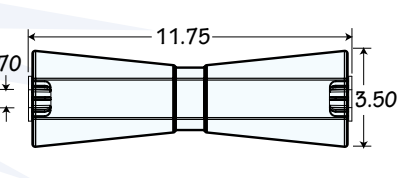

Keel Roller 12 in.
Part ID: **48379/48724**

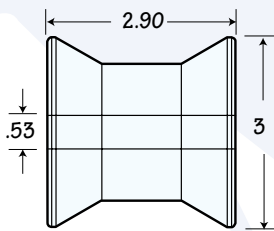

Bow Roller 3 in.
Part ID: **48653/48381**

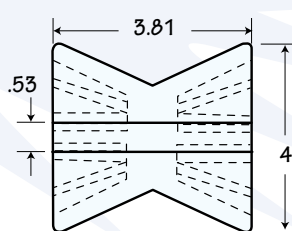

Bow Roller 4 in.
Part ID: **48651/48716**

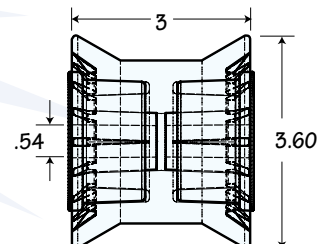

Heavy Duty Bow Roller 3 in.
Part ID: **48673**

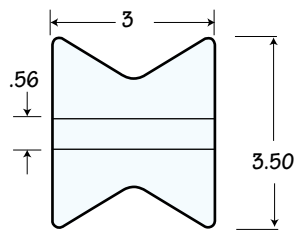

Bow Roller 3 in.
Part ID: **48771/48391**

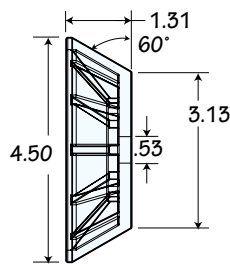

End Bell 3 in.
Part ID: **48654/48669**

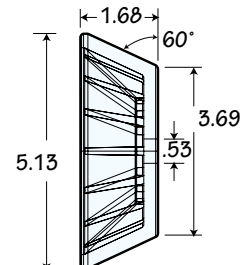

End Bell 4 in.
Part ID: **48652/48717**

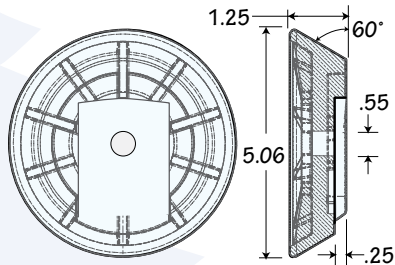

Notched End Bell 4 in.
Part ID: **48674**

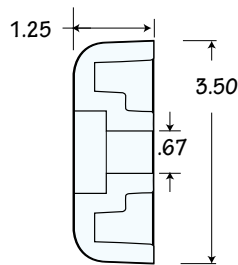

End Cap 3 in.
Part ID: **48358/48725**

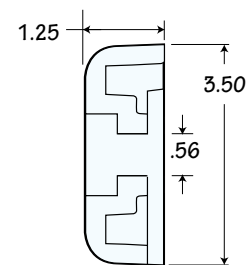

Notched End Cap 3 in.
Part ID: **48770/48398**

ROLLERS & BUNK SLICKS

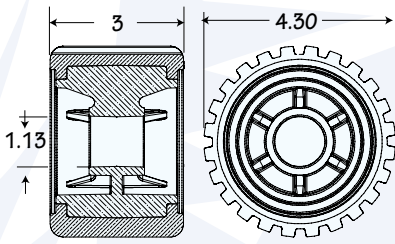

Wobble Roller 4 in. Ribbed
Part ID: **46436**

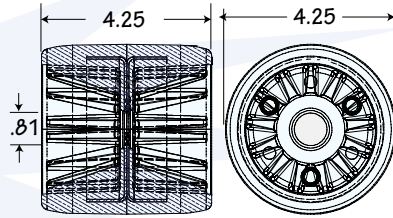

Wobble Roller 4 in. Smooth
Part ID: **46437**

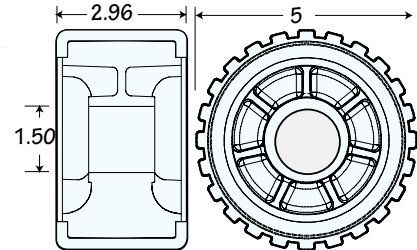

Wobble Roller 5 in.
Part ID: **48662/48719**

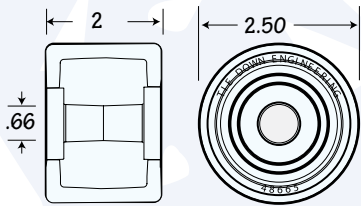

Roller 2 in. x 2.50 in.
Part ID: **48665**

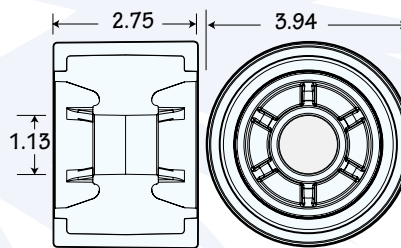

Roller 4 in. x 2.75 in.
Part ID: **48666**

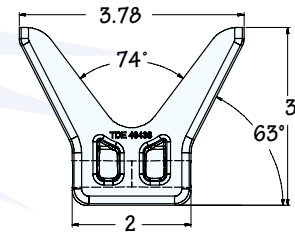

"Y" Bow Block 2 in.
Part ID: **46438**

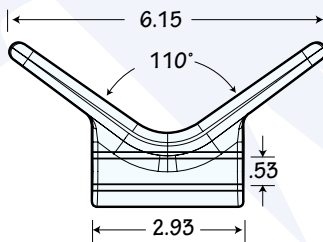

"Y" Bow Stop 3 in.
Part ID: **48372/48726**

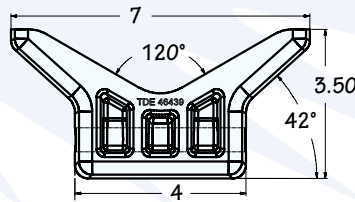

"Y" Bow Block 4 in.
Part ID: **46439**

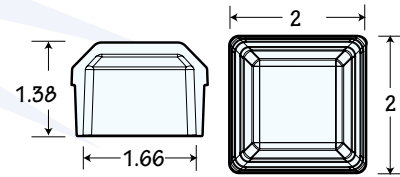

End Cap 2 in. x 2 in.
Part ID: **48363**

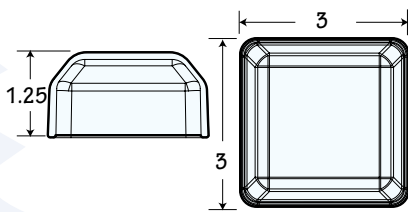

Post Cap 3 in. x 3 in.
Part ID: **48375**

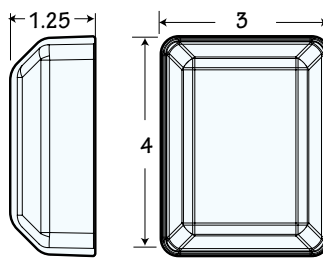

Post Cap 4 in. x 3 in.
Part ID: **48368**

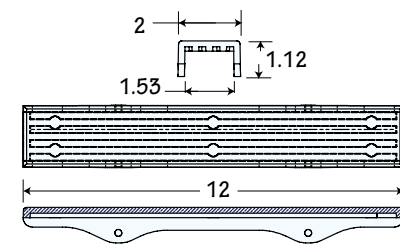

Keel Pad 2 in. x 12 in.
Part ID: **48675**

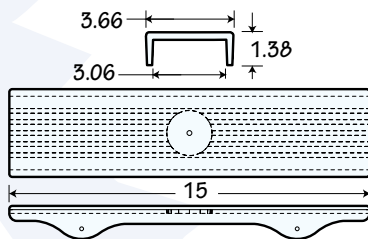

Keel Pad 3.5 in. x 15 in.
Part ID: **48650/48382**

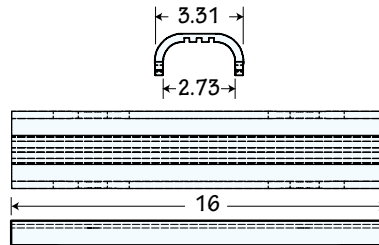

Torsion Axle Keel Pad
Part ID: **48663**

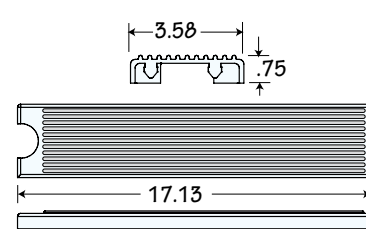

Pontoon Step Pad
Part ID: **43632-10A/43632-10**

ROLLERS & BUNK SLICKS

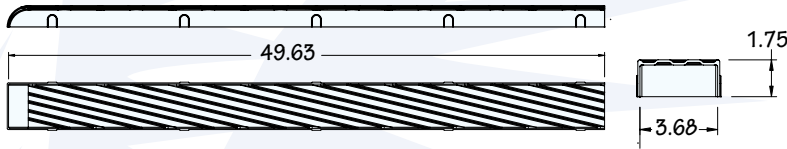

Bunk Glide On's, 2 in. x 4 in. x 4 ft.
Part ID: **86002/86004**

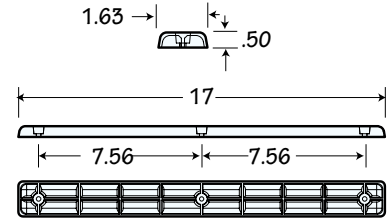

Bunk Slick 1.75 in. x 17 in.
Part ID: **48668**

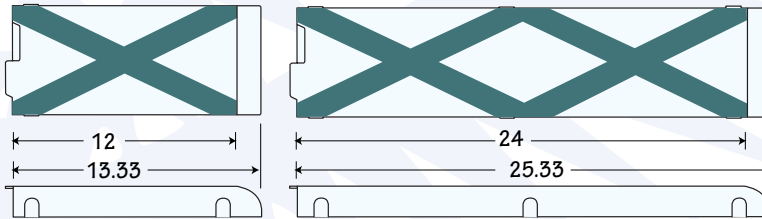

Modular Self Centering Glide On's
1ft. End Section
Part ID: **46964/46964W**

Modular Self Centering Glide On's
2ft. End Section
Part ID: **46965**

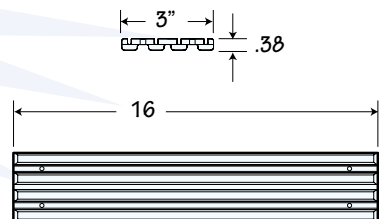

Bunk Slick 3 in. x 16 in.
Part ID: **48667**

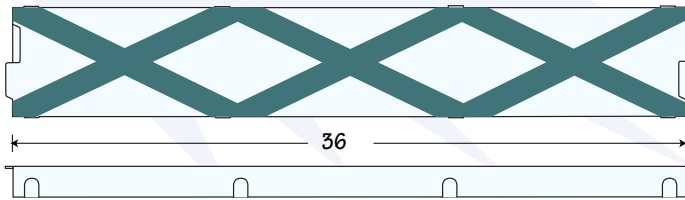

Modular Self Centering Glide On's 3ft. Center Section
Part ID: **46966/46966W**

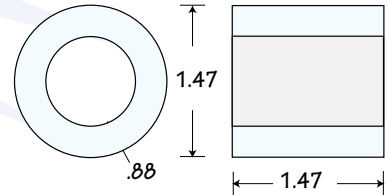

Bushing 7/8 in.
Part ID: **48369**

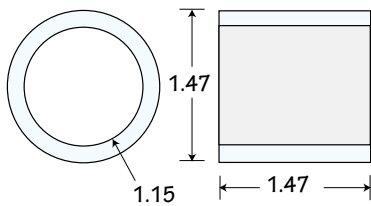

Bushing 1.15 in.
Part ID: **48370**

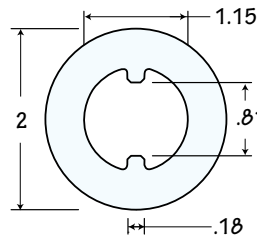

Keyed Roller Washer - 10 ga.
Part ID: **45021**

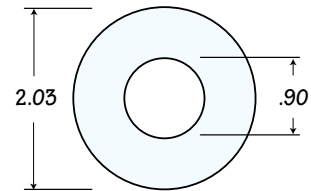

Roller Washer - 10 ga.
Part ID: **45020**

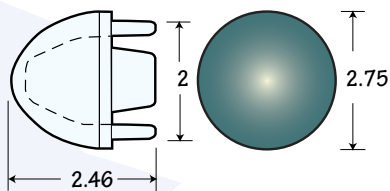

PVC End Caps
Part ID: **48353/48353F**

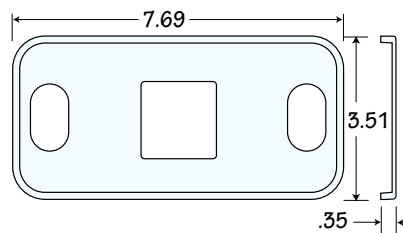

Isolation Pad
Part ID: **46967**

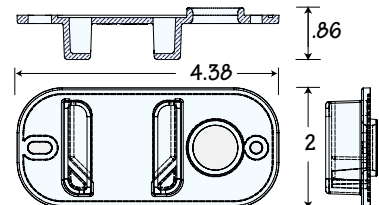

Wiring Harness Storage Saddle
Part ID: **43643**

ROLLERS & BUNK SLICKS

Tie Down's patented modular roller bunks provide a cost effective system for roller trailers. Patented pivot block provides for either dual or quad roller applications.

U. S. Patent #5,316,329

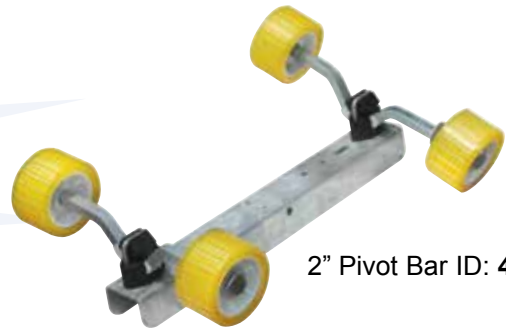

2" Pivot Bar ID: **45017**

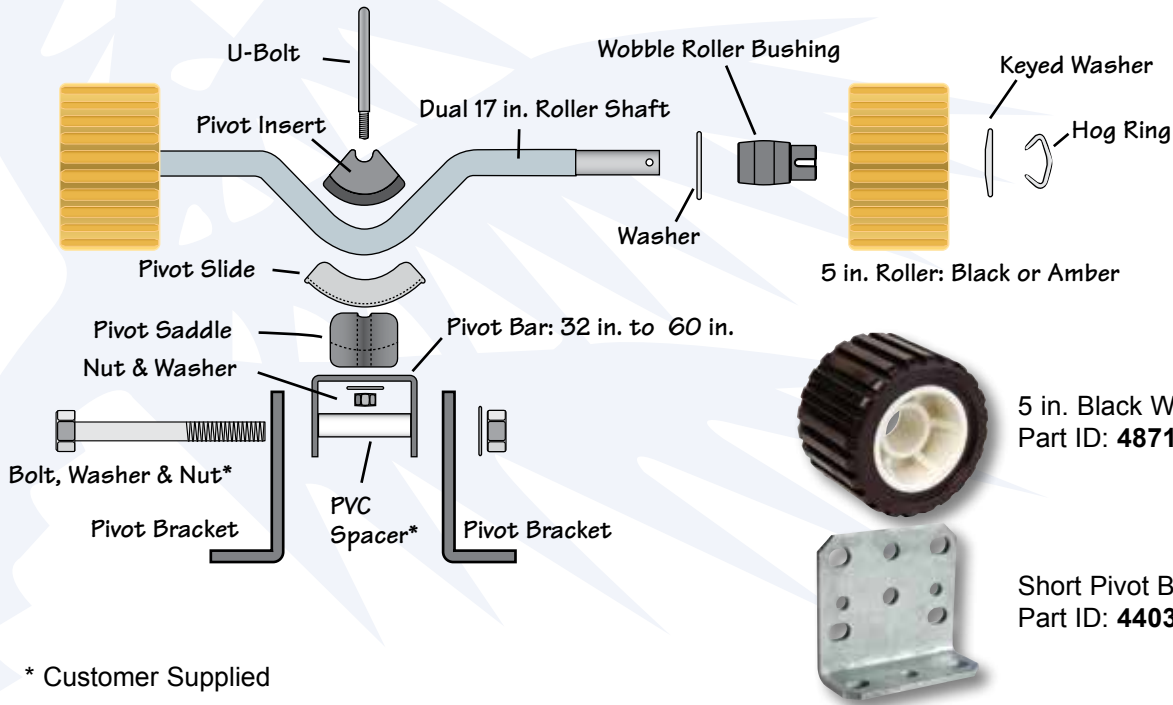

* Customer Supplied

Part ID:	Description	Information
44035	Pivot Bracket (short)	Used in pairs to mount pivot bars to frame
45017	Pivot Bar 32 in., 2 roller shaft positions	Pivot bar selected on support required, 4 rollers
45039	Pivot Bar 36 in., 6 roller shaft positions	Pivot bar selected on support required, 12 rollers
45040	Pivot Bar 48 in., 8 roller shaft positions	Pivot bar selected on support required, 16/20 rollers
45005	Block Pivot Saddle	Mounts roller shaft and slide to pivot bar with u-bolts
45006	Pivot Slide	Used on shaft
45007	Pivot Insert	Top half of pivot assembly
45008	Pivot U-bolt 3/8 in.-16 x 1.63 in.x 3.75 in.	Mounts assembly to pivot bar
45009	Pivot U-bolt 3/8 in.-16 x 1.63 in.x 6.31 in.	Mounts assembly to pivot bar
45052	Shaft Roller, 17 in.	Mounts 2 (dual) rollers
45021	Washer (keyed)	Outer washer
45020	Washer (flat)	Inner washer
86258	Hog Rings (Bulk 100)	Secures roller assembly
48662	Wobble Roller, 5 in. amber	Wobble roller
48719	Wobble Roller, 5 in. black	Wobble roller
48647	Roller Bushing (end unit)	Used inside 5 in. wobble rollers

Important: For design purposes each roller is rated at 200#.

ROLLERS & BUNK SLICKS

KEEL ROLLER BRACKET

Adjustable offset brackets mount on tongue for keel support. Assembled version comes complete with 4 in. rubber roller (for 2 in. wide tongue) and hardware as shown. Brackets are made out of 3/16 in. material.

Bracket, one only (2 required)
Part ID: **44017**

Assembled with roller, shaft, nuts and bolts. (shown right)
Part ID: **86121**

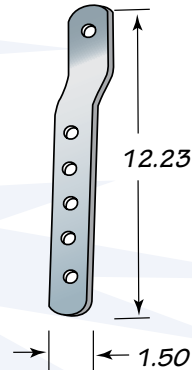

PANEL BRACKET

Brackets are one piece, heavy duty hot dip galvanized 11 ga. steel, specifically designed to support keel rollers. Slots accept 7/16 in. or 1/2 in. diameter bolts and provide vertical roller adjustment. Roller shaft diameter can be 1/2 in. or 5/8 in.

Part ID:	Roller Size	A	B	C	Slot
86150	4.0	3.25	4.38	7.0	5.0 x 0.53
86151G	5.0	3.25	5.38	7.0	5.0 x 0.53
86152G	8.0	3.25	8.38	7.0	5.0 x 0.53
86155G	10.0	3.25	10.38	7.0	5.0 x 0.53
86153G	12.0	3.25	12.38	7.0	5.0 x 0.53

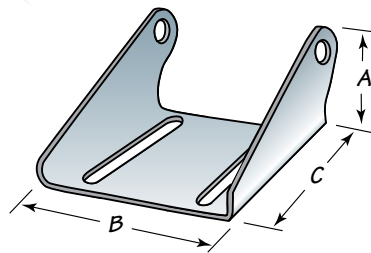

SPLIT PANEL BRACKETS

Sold in pairs (right and left) to accommodate any size roller length. Slot allows vertical adjustment for stabilizing boat on trailer. Slots accept 7/16 in. or 1/2 in. bolts. Use 1/2 in. or 5/8 in. roller shaft.

Part ID: **86140**

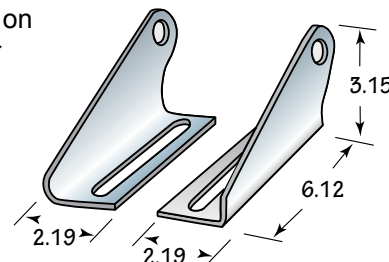

TIE DOWN ROLLERS & BUNK SLICKS

ROLLER SHAFTS

Description (Bulk)	Zinc Finish	Galvanized Finish
1/2 in. X 5-1/4 in.	86035	N/A
1/2 in. X 6-1/4 in.	86036	N/A
1/2 in. x 12-3/4 in.	44614	N/A
1/2 in. X 13-1/2 in.	44615	N/A
5/8 in. X 5-1/4 in.	86037	86178
5/8 in. X 6-1/4 in.	86038	86179
5/8 in. X 9-1/4 in.	86039	86180
5/8 in. X 11-1/4 in.	86040	86181
5/8 in. X 13-1/4 in.	86041	86182
5/8 in. X 15-1/4 in.	86042	N/A
5/8 in. X 19-1/4 in.	86043	N/A

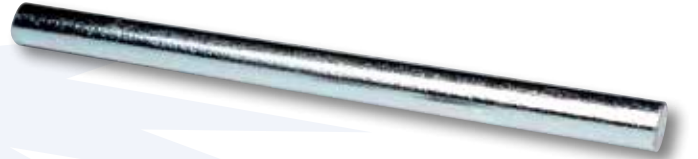

CAP NUTS

1/2 in. Pal Nuts (50 per box)	Part ID: 86300
5/8 in. Pal Nuts (50 per box)	Part ID: 86301



CABLES, CHAINS, & STRAP



Replace your noisy chains with self-coiling hitch cables from Tie Down. Our durable galvanized aircraft cable construction is available in plain or vinyl coating and exceeds SAE J684 standards for trailer coupling as well as automotive. Tie Down promotes the concept of removing the coating around the compression sleeve prior to swaging, while our innovative vinyl coated cable loops include protective steel thimbles in order to protect against excessive wear and tear.

Part ID:	Description	Breaking Strength	Class	Cable Length	Hook Type
50534	Black Coated PVC, Pair	2,800	1	36	SL
50536	Galvanized, Pair	3,500	2	36	SL
50538	Black Coated PVC, Pair	3,500	2	36	SL
50513	Black Coated PVC, Pair	5,000	3	24	SL
50540	Galvanized, Pair	5,000	3	36	SL
50542	Black Coated PVC, Pair	5,000	3	36	SL
50569	Black Coated PVC, Pair	5,000	3	50	SL
50516	Black Coated PVC, Pair	7,000	4	17	SL
50593	Black Coated PVC, Pair	7,000	4	30	LA
50529	Black Coated PVC, Pair	7,000	4	36	LA
50544	Galvanized, Pair	7,000	4	36	SL
50546	Black Coated PVC, Pair	7,000	4	36	SL
50549	Galvanized, Pair	7,000	4	36	LA
50574	Black Coated PVC, Pair	7,000	4	42	SL
50541	Black Coated PVC, Pair	7,000	4	46	LA
50563	Black Coated PVC, Pair	7,000	4	48	SL
50564	Black Coated PVC, Pair	7,000	4	48	LA
50547	Black Coated PVC, Pair	7,000	4	54	SL
50522	Yellow Coated PVC, Pair	7,000	4	60	LA
50576	Black Coated PVC, Pair (1/2 straight/coiled)	7,000	4	60	SL
50576X	Black Coated PVC, Pair	7,000	4	60	SL
50548	Galvanized, Pair	7,500	4	36	LA
50528	Black Coated PVC, Pair	7,500	4	36	LA
50557	Black Coated PVC, Pair	10,000	4	46	LA
50520	Galvanized, Pair	10,000	4	36	LA
50585	Black Coated PVC, Pair	10,000	4	56	LA
50589	Black Coated PVC, Pair	10,000	4	66	LA
50512	Black Coated PVC, Pair	12,000	4	30	LA
50508	Black Coated PVC, Pair	12,000	4	42	LA
50510	Black Coated PVC, Pair	12,000	4	36	LA
50517	Black Coated PVC, Pair	12,000	4	48	LA
50518	Red Coated PVC, Pair	12,000	4	48	LA
50502	Black Coated PVC, Pair	14,400	4	36	LA
50503	Black Coated PVC, Pair	14,400	4	48	LA
50571	Black Coated PVC, Pair	18,400	4	30	LA
50523	Black Coated PVC, Pair	18,400	4	52	LA

Hook Type Descriptions:

SL - S-Hook with wire Latch

LA - Latch hook

NH - No Hook

TIE DOWN CABLES, CHAINS, & STRAP

BOW SAFETY CHAIN

Zinc plated trailer safety chains with S-hooks.

Part ID:	Description
46496	Class 2, 3/16 in. x 28 in., (OAL 31 in.)
46497	Class 3, 1/4 in. x 26 in., (OAL 31 in.)
46498	Class 4, 5/16 in. x 38 in., (OAL 40-3/4 in.)



SAFETY CHAINS

Tie Down Bow Safety Chain connects the boat to the bow stand of the trailer. 3/16 in. x 15.5 in. OAL

Part ID: **46499**



“S” HOOK SAFETY CHAIN KEEPERS

These patented safety chain keepers attach easily to the “S” hooks to keep your chains secured to the vehicle. (required in some states)

Bulk Part ID: **17465**



CABLES, CHAINS, & STRAP

WINCH STRAPS

Winch straps are 2 in. wide and have an overall tensile strength of 5000#. Each strap comes with a heavy duty forged latch hook.

Part ID:	Description
46502	2 in. X 15 ft. Winch Strap (5000#)
50460LS	2 in. x 15 ft. Winch Strap w/PWC Tail (5000#)
50461B	2 in. x 12 ft. with PWC Strap (5000#)
46504	2 in. x 20 ft. Winch Strap (5000#)
46505	2 in. x 25 ft. Winch Strap (5000#)



WINCH CABLES

Galvanized steel 7 x 19 aircraft cable. Each cable is fitted with a heavy duty galvanized latch hook, pull proof loop and a fastener end.

Part #	Description
46506	1/8 in. x 20 ft.
46507	3/16 in. x 25 ft.
46508	3/16 in. x 50 ft.
46509	7/32 in. x 25 ft.
46511	7/32 in. x 50 ft.

Refer to winch manufactures recommendations for proper size cable and capacity.



CABLES, CHAINS, & STRAP

HOOKS

Hooks are an important part of the cable assembly. All our hooks are zinc plated for corrosion protection. Many states require latch hooks or “keepers” on the hooks to secure the cable to the tow vehicle. Check your state laws.

#	Part ID:	Description	Breaking Strength
A	13125	Hook, Latch for 1/2" Cable	36,000
B	13106	Latch Hook (small version)	21,000
C	13100	XEA EY Latch Hook	12,000
D	13118	XDL90 Latch Hook	8,000
E	13119	XBC55 Latch Hook	7,500
F	18472	“S” Hook 1/2 in.	8,900
G	18476	“S” Hook 1/2 in. w/wire latch	8,900
H	18473	“S” Hook 7/16 in.	5,000
I	18475	“S” Hook 7/16 in. w/wire latch	5,000
J	18471	“S” Hook 3/8 in.	3,500
K	18474	“S” Hook 3/8 in. w/wire latch	3,500
L	13115	“S” Hook 13/32 in.	3,000
M	18477	“S” Hook 13/32 in. w/wire latch	3,000
N	17465	“S” Hook Safety Chain Keepers	

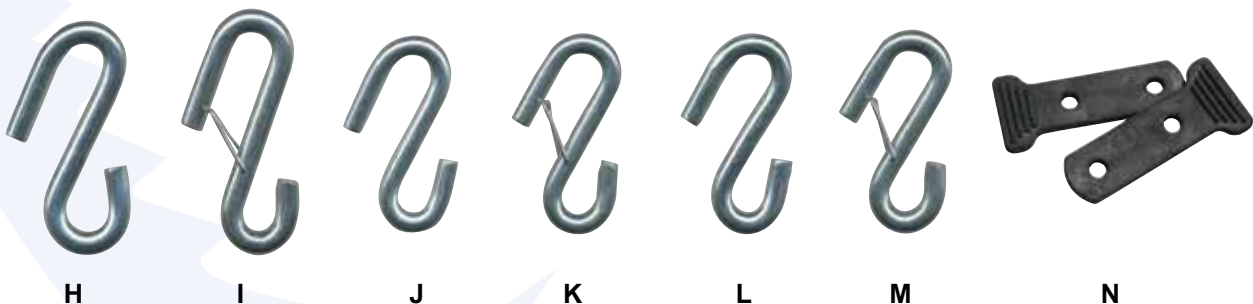
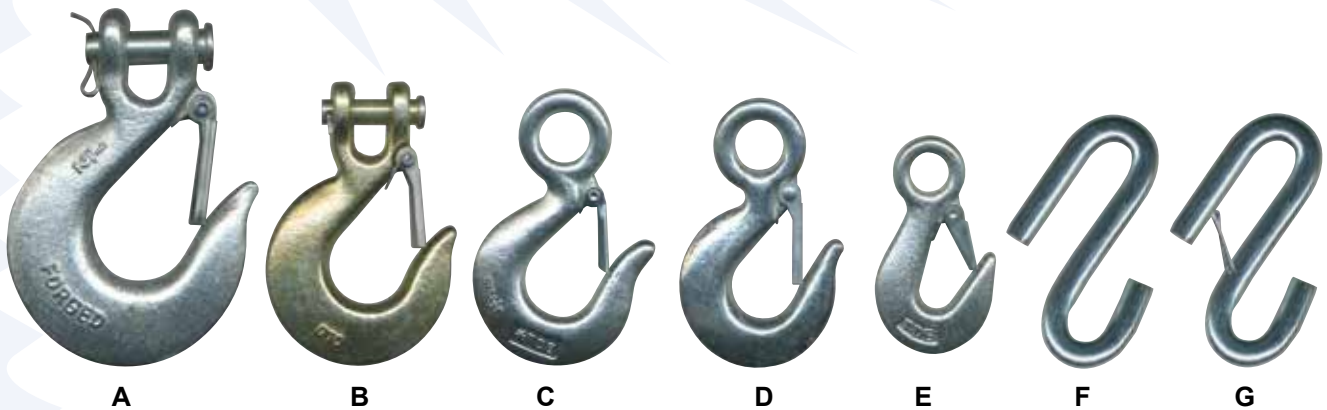

SPARE TIRE CARRIERS

ELIMINATOR SPINDLE/TIRE CARRIERS

The Eliminator Torsion/Spindle Axle has an industry first with its removable spindle. Gone are the days of sitting by the side of the road when the spindle is damaged due to extreme bearing failure or due to an accident. Mount with u-bolts or backing plate and hex head bolts.



Part ID:	Description	Hub Capacity	Gauge	Frame Sizes
48049	Spare Tire Carrier for Tongue Mount	1750#/1875#	11	3, 4, & 5
48049F	Spare Tire Carrier for Tongue Mount, includes Hub and Spindle	1750#/1875#	11	3, 4, & 5
48054	Spare Tire Carrier for Tongue Mount	1750#/1875#	11	3, 4, & 5
48054F	Spare Tire Carrier for Tongue Mount, includes Hub and Spindle	1750#/1875#	11	3, 4, & 5
48059	Spare Tire Carrier for I-Beam Mount	1750#/1875#	1/4	I-Beam
48059AG	Spare Tire Carrier for I-Beam Mount, includes Hub and Spindle	1750#/1875#	1/4	I-Beam
48062	Spare Tire Carrier for Tongue Mount	1750#/1875#	3/16	3 - 6
48062G	Spare Tire Carrier for Tongue Mount, includes Hub and Spindle	1750#/1875#	3/16	3 - 6
48063	Spare Tire Carrier for Tongue Mount	3000#	11	3, 4, & 5
48063F	Spare Tire Carrier for Tongue Mount, includes Hub and Spindle	3000#	11	3, 4, & 5
48097	Spare Tire Carrier for I-Beam Mount	3000#	11	I-Beam
48097G	Spare Tire Carrier for I-Beam Mount, includes Hub and Spindle	3000#	11	I-Beam
48099	Backing Plate, for use with I-Beam Mount Carrier 48097		1/4	I-Beam
48054-2	Backing Plate, for use with 48049 & 48054		1/4	3, 4, & 5
48061	Backing Plate, for use with 48063 & 48062		1/4	3 - 6

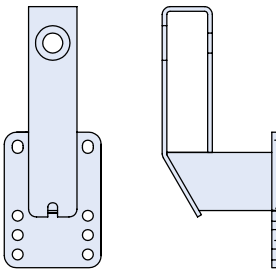

Part #48049

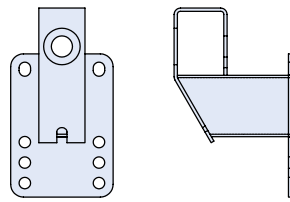

Part #48054

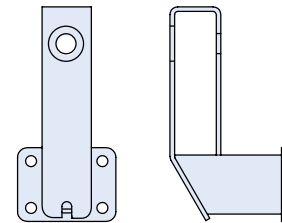

Part #48059

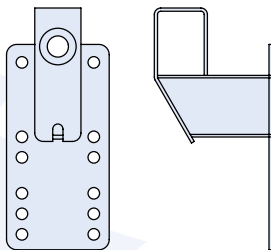

Part #48062

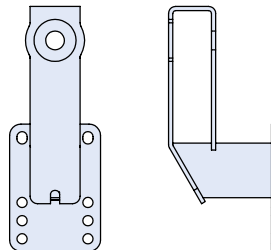

Part #48063

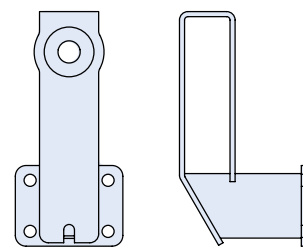

Part #48097

TIE DOWN SPARE TIRE CARRIERS

SIDE MOUNT TIRE CARRIER

- Adjustable bolt circle fits both 4 lug and 5 lug wheels
- Offset height raises tire and provides additional ground clearance
- Security holes provide for optional cable and lock (not included)
- Hot dip galvanized or zinc plated for lasting protection
- Fits all trailer tongues up to 3 in. wide by 4 in. high
- Extra heavy duty welded steel construction
- Hardware not included
- U.S. Patent #6,116,483

“Bolt On” Models:

Part ID: **48055G** Galvanized

Part ID: **48055** Zinc plated

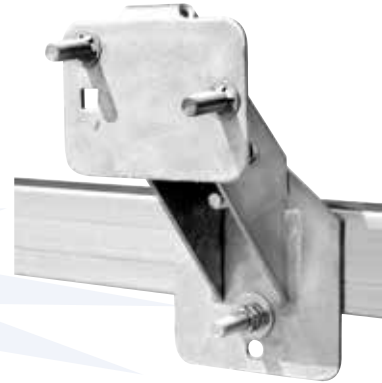

SIDE MOUNT TIRE CARRIER WITH SPINDLE

- Heavy duty steel carrier mounts both spare hub & spare tire
- Designed for 1750# hub with 1-1/16 in. and 1-3/8 in. bearings
- Fits all trailer frames up to 3 in. wide and 4 in. high
- Security holes for optional cable & lock
- Hardware not included

Part ID: **48056**

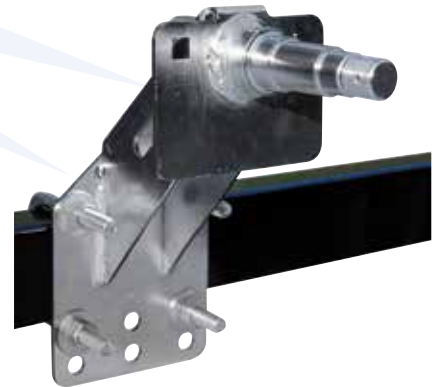

HIGH MOUNT TIRE CARRIER

Accommodates 4, 5, and 6 lug wheels. Hot dip galvanized for lasting protection. Fits all trailer frames up to 3 in. wide by 4 in. high. Heavy duty steel tubing. Retail boxed with hardware.

Part ID: **86101**



TIED DOWN SPARE TIRE CARRIERS

TIRE CARRIER

Accommodates 4, 5, and 6 lug wheels. Hot dip galvanized for lasting protection. Fits all trailer frames up to 6 in. high. Heavy duty steel tubing.

Tire Carrier Only, no hardware Part ID: **48102**
Mounting Bracket - 2 required Part ID: **48102-4**

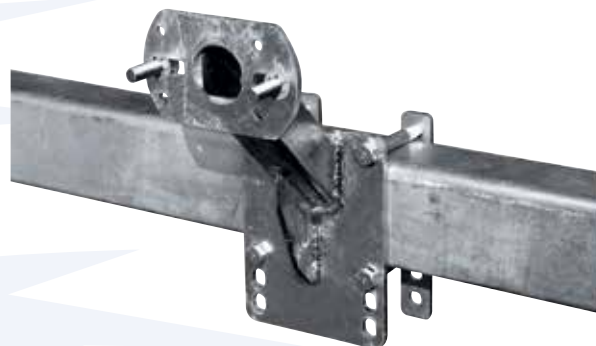

HEAVY DUTY TIRE CARRIER

Designed for use with large tube, I-beam and aluminum trailers. Heavy duty steel carrier mounts larger spare tires. Adjustable bolts circle accommodates 4, 5, 6 & 8 lug wheels. Designed to fit trailer frames 3 in. up to 8 in.

Part ID: **70305**

